

CONSTRUCTION NOTES:

1. CONTRACTOR TO INSTALL AND RESET STRIPING. ALL PROPOSED STRIPING TO MATCH EXISTING.
2. EXCEPT FOR THE INLETS DESIGNATED ON THE PLANS TO BE RECONSTRUCTED, ALL REMAINING INLETS SHALL BE RESET. ALL RESET CASTINGS SHALL BE INCLUDED IN THE BID ITEM PRICE FOR "CLEARING SITE". NO SEPARATE PAYMENT WILL BE MADE FOR THIS WORK.
3. CONTRACTOR TO SAWCUT AT LIMITS OF PAVING (L.O.P.) AND AROUND THE CONCRETE TRENCH DRAIN. NO SEPARATE PAYMENT FOR THIS WORK.
4. LIMITS OF PAVING SHALL BE TACKED AND SEALED. THERE SHALL BE NO SEPARATE PAYMENT FOR THIS WORK.
5. ALL LIMITS OF PAVING SHALL BE VERIFIED IN THE FIELD WITH THE ENGINEER.
6. ALL LIMITS OF GRANITE CURB REPLACEMENT SHALL BE VERIFIED IN THE FIELD WITH THE ENGINEER PRIOR TO THE START OF CONSTRUCTION.
7. LIMITS OF TRENCH DRAIN REPAIR SHALL BE VERIFIED IN THE FIELD WITH THE ENGINEER PRIOR TO THE START OF CONSTRUCTION.

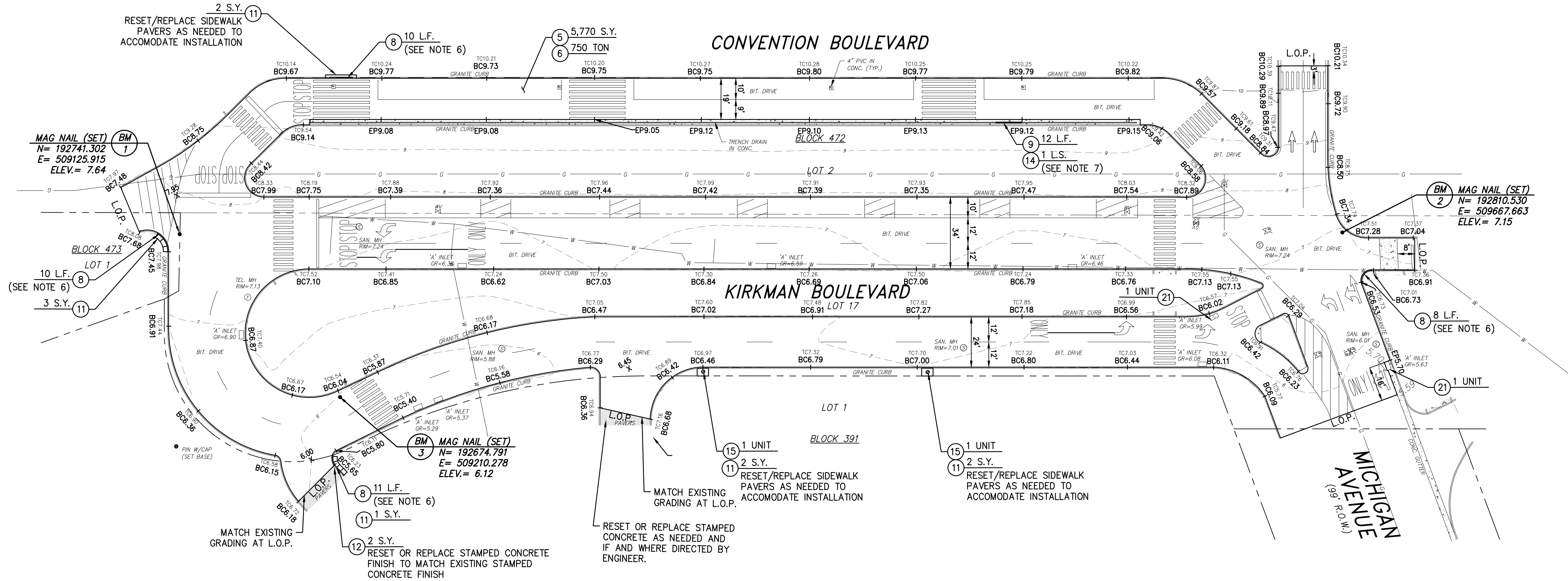

PLAN
SCALE: 1" = 30'

SURVEY NOTES:

1. THE HORIZONTAL DATUM IS BASED ON THE NEW JERSEY STATE PLANE COORDINATE SYSTEM (NAD-83/2011 ADJ.) AND THE VERTICAL DATUM IS BASED ON NAVD-1988/GEOD 2018. (ADD 1.33 FEET TO THESE ELEVATIONS TO CONVERT TO NGVD-1929 DATUM)
2. PROPERTY AND RIGHT-OF-WAY LINES SHOWN ON THESE PLANS ARE APPROXIMATE LOCATIONS BASED ON THE CURRENT TAX MAPS OF THE CITY OF ATLANTIC CITY, ATLANTIC COUNTY, NEW JERSEY. PROPERTY AND RIGHT-OF-WAY LINES ARE SHOWN FOR GRAPHICAL INFORMATION ONLY AND HAVE NOT BEEN FIELD VERIFIED.
3. EXISTING TOPOGRAPHIC CONDITIONS WERE SURVEYED BY REMINGTON & VERNICK ENGINEERS UNDER THE SUPERVISION OF CHARLES E. ADAMSON, N.J.P.L.S. LICENSE NO. 42627. THE SURVEY WORK WAS COMPLETED ON AUGUST 8, 2025.
4. THIS PLAN AND SURVEY DOES NOT CERTIFY TO THE LOCATION, BOTH HORIZONTAL AND VERTICAL OF ANY UNDERGROUND UTILITY OR STRUCTURE THAT WAS NOT EXPOSED FOR DIRECT MEASUREMENT.

TO BE CONSTRUCTED				
ITEM NO.	DESCRIPTION	UNIT	PLAN QUANTITY	AS-BUILT QUANTITY
5	MILLING, 3" OR LESS	S.Y.	5,770	
6	HOT MIX ASPHALT 12.5M76 SURFACE COURSE, 2" THICK	TON	750	
8	GRANITE CURB	L.F.	39	
9	8" X 30" CONCRETE CUTTER	L.F.	12	
11	RESET SIDEWALK PAVERS	S.Y.	10	
12	STAMPED CONCRETE, 8" THICK	S.Y.	2	
14	TRENCH DRAIN REPAIR (ALLOWANCE)	L.S.	1	
15	REPLACE BOLLARD LIGHTING	UNIT	2	
21	RECONSTRUCTED INLET, TYPE A, USING EXISTING CASTING	UNIT	2	

RVE
1901

REMINGTON & VERNICK ENGINEERS

2819 FIRE ROAD, 1ST FLOOR
EGG HARBOR TOWNSHIP, NJ 08234
(609) 645-7110, FAX (609) 645-7076
WEB ADDRESS : RVE.COM
Certification of Authorization: 24 GA 28003300
Excellence • Innovation • Service

Nicholas R. DiCosmo
NICHOLAS R. DICOSMO
NJ PROFESSIONAL ENGINEER LIC. No. 57899

Joseph H. Johnston
JOSEPH H. JOHNSTON
NJ PROFESSIONAL ENGINEER LIC. No. 35729

PLANS WHICH DO NOT BEAR AN EMBOSSED SEAL OR DIGITAL SEAL ARE NOT VALID.

ALL DOCUMENTS PREPARED BY REMINGTON & VERNICK ENGINEERS AND AFFILIATES ARE INSTRUMENTS OF SERVICE IN RESPECT OF THE PROJECT. THEY ARE NOT INTENDED OR REPRESENTED TO BE SUITABLE FOR REUSE BY OWNER OR OTHERS ON EXTENSIONS OF THE PROJECT OR ON ANY OTHER PROJECT. ANY REUSE WITHOUT WRITTEN VERIFICATION OR ADAPTATION BY REMINGTON & VERNICK ENGINEERS AND AFFILIATES FOR THE SPECIFIC PURPOSE INTENDED WILL BE AT OWNERS SOLE RISK AND WITHOUT LIABILITY OR LEGAL EXPOSURE TO REMINGTON & VERNICK ENGINEERS AND AFFILIATES. OWNER SHALL INDEMNIFY AND HOLD HARMLESS REMINGTON & VERNICK ENGINEERS AND AFFILIATES FROM ALL CLAIMS, DAMAGES, LOSSES AND EXPENSES ARISING OUT OF OR RESULTING THEREFROM.

NO.	REVISION	DATE	BY	CHK

CONSTRUCTION AND GRADING PLAN

GLOBAL SPECTRUM L.P.
CONVENTION BOULEVARD RESURFACING
CITY OF ATLANTIC CITY
ATLANTIC COUNTY
NEW JERSEY

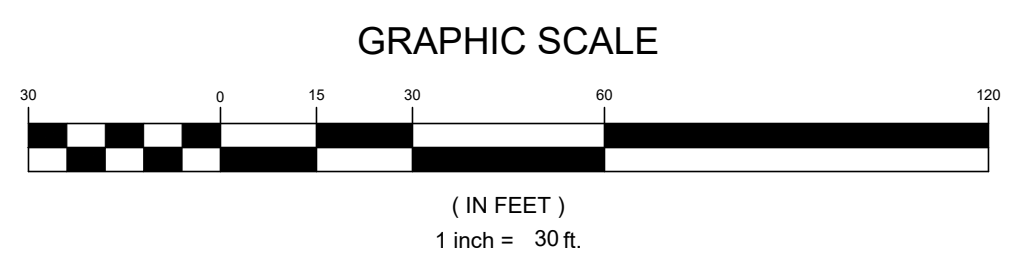

DRAWN BY	DESIGN BY	CHECKED BY	SCALE
DW	N.R.D.	J.E.J.	AS NOTED
DATE:	9/4/2025	SHEET No.:	5 of 10
JOB No.:	60-37-J-001		

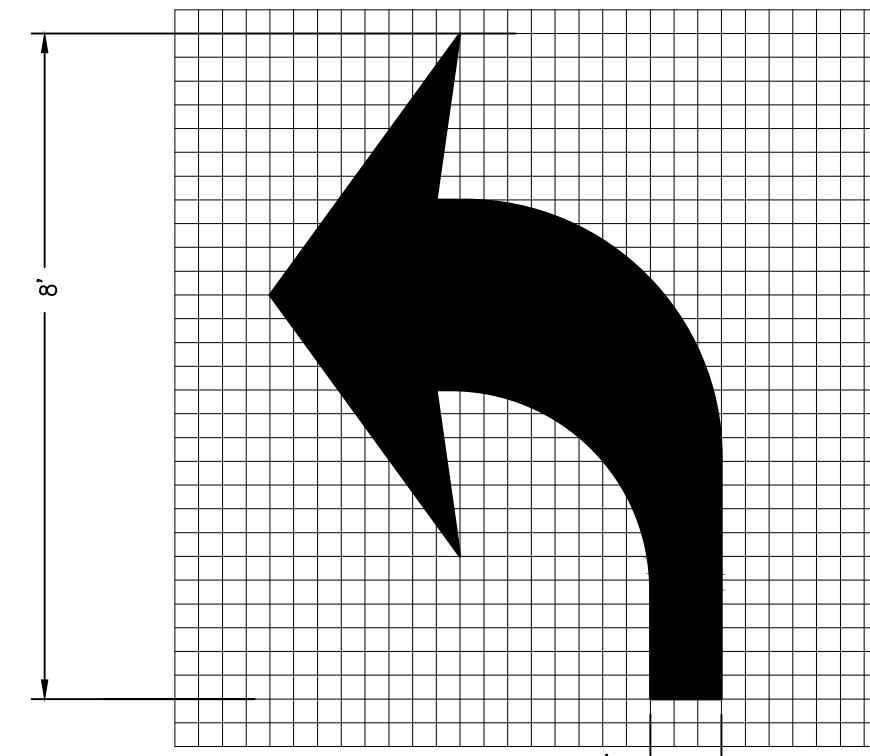

AREA = 15.0 S.F.

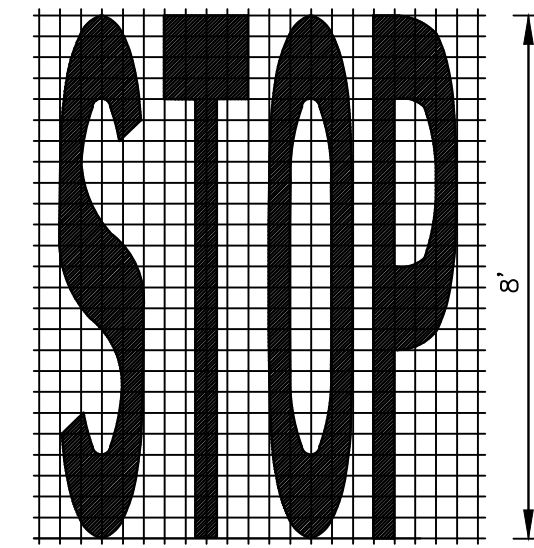

AREA = 32.0 S.F.

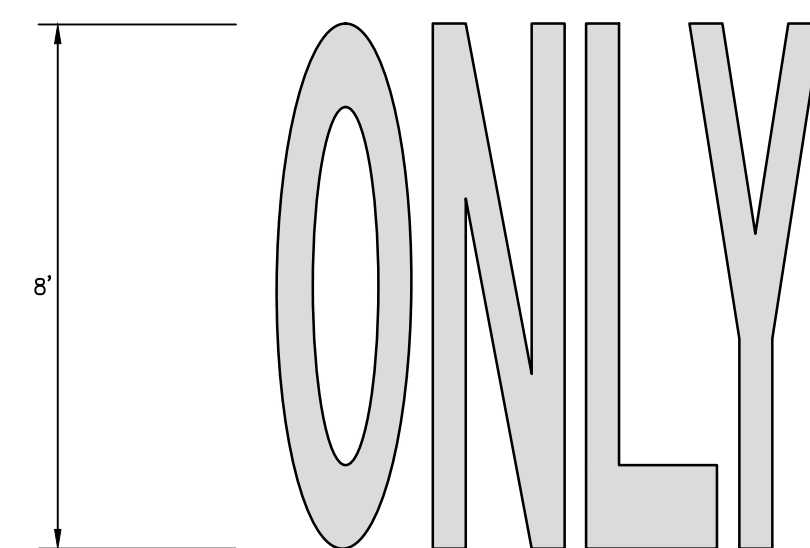

AREA = 31.0 S.F.

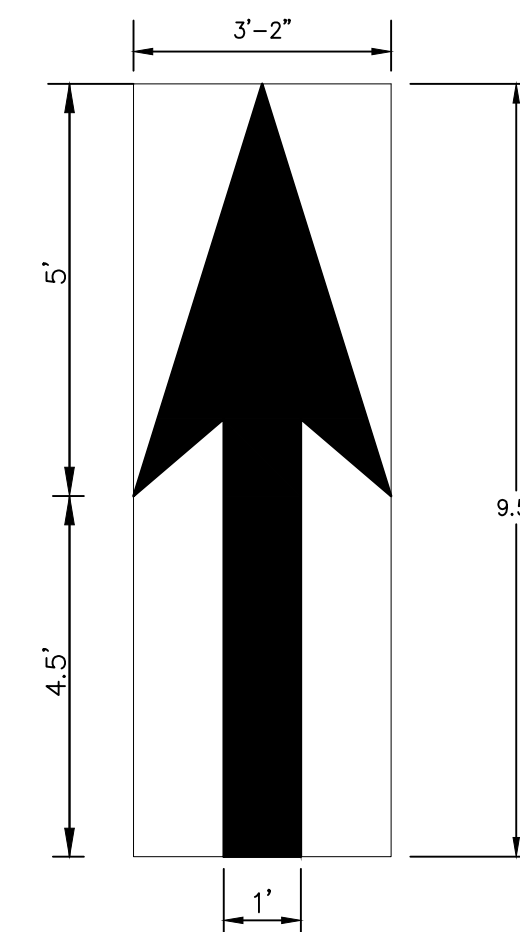

AREA = 12.0 S.F.

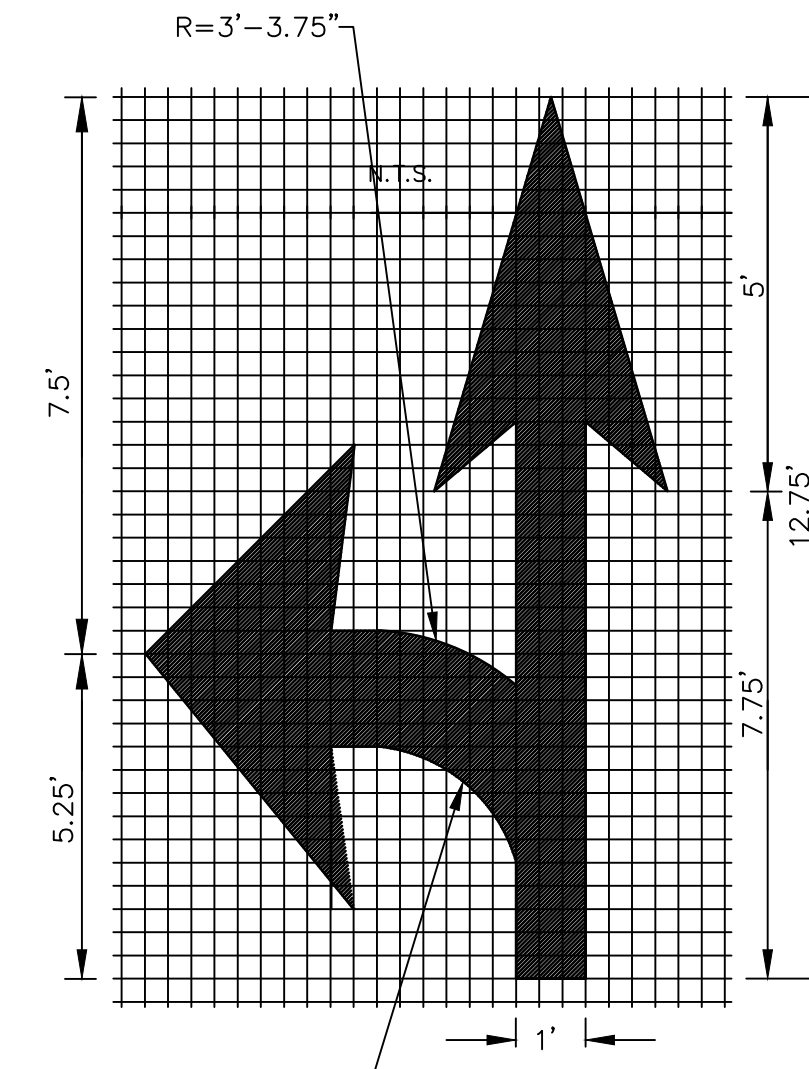

AREA = 27.0 S.F.

NOTES:

1. TRAFFIC MARKING SHALL BE THERMOPLASTIC.
2. TRAFFIC MARKING SHALL BE INSTALLED IN THE CENTER OF THE LANE.
3. HEIGHT OF LETTERS AND LONGITUDINAL SPACING BETWEEN MARKINGS TO BE VERIFIED BY ENGINEER.

TRAFFIC MARKING SYMBOLS DETAIL

N.T.S.

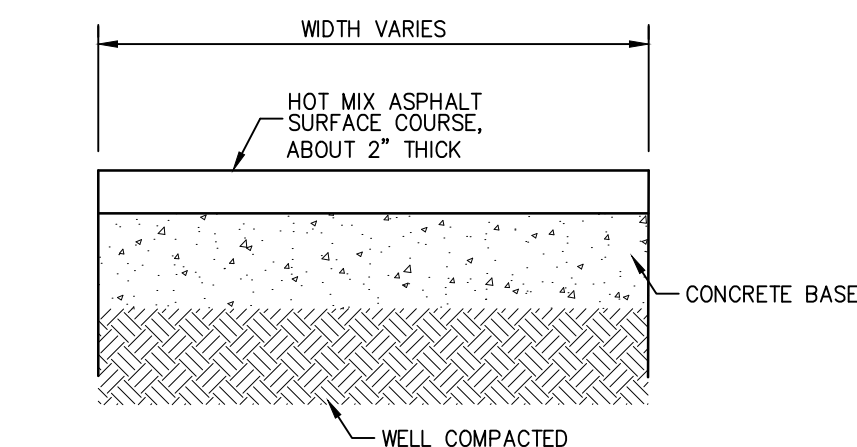

EXISTING TYPICAL SECTION

N.T.S.

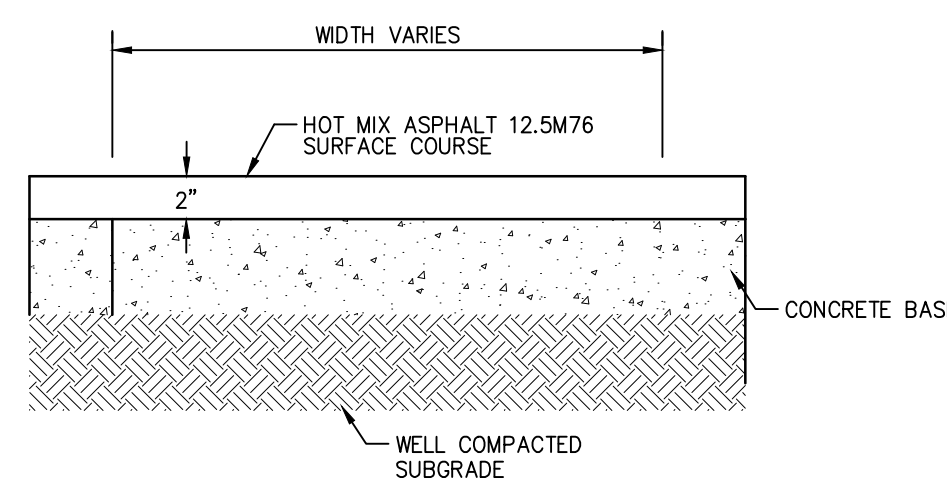

TYPICAL CONCRETE BASE REPAIR SECTION

N.T.S.

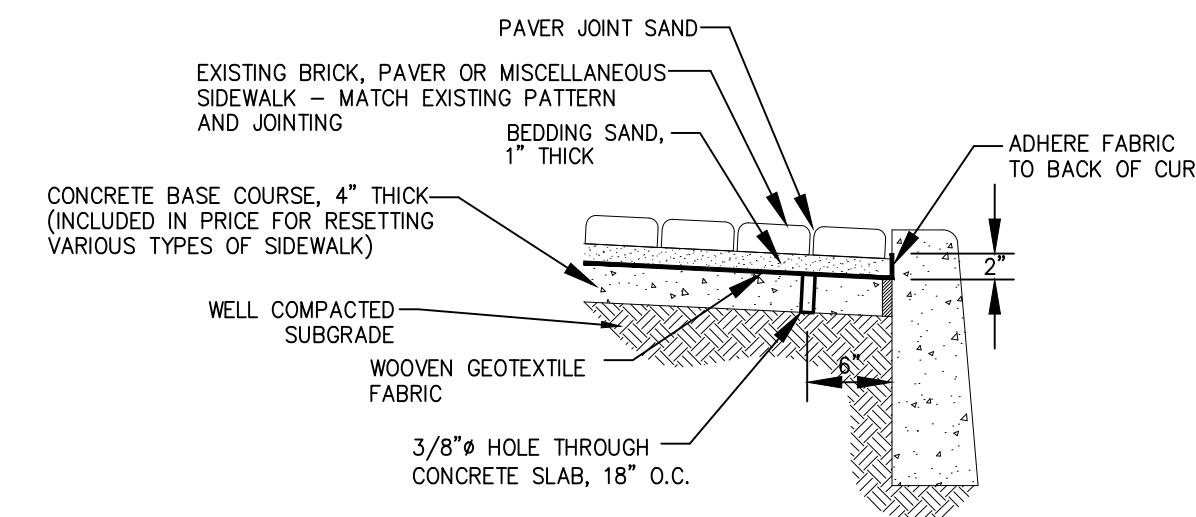

RESET BRICK, PAVER OR MISCELLANEOUS SIDEWALK

N.T.S.

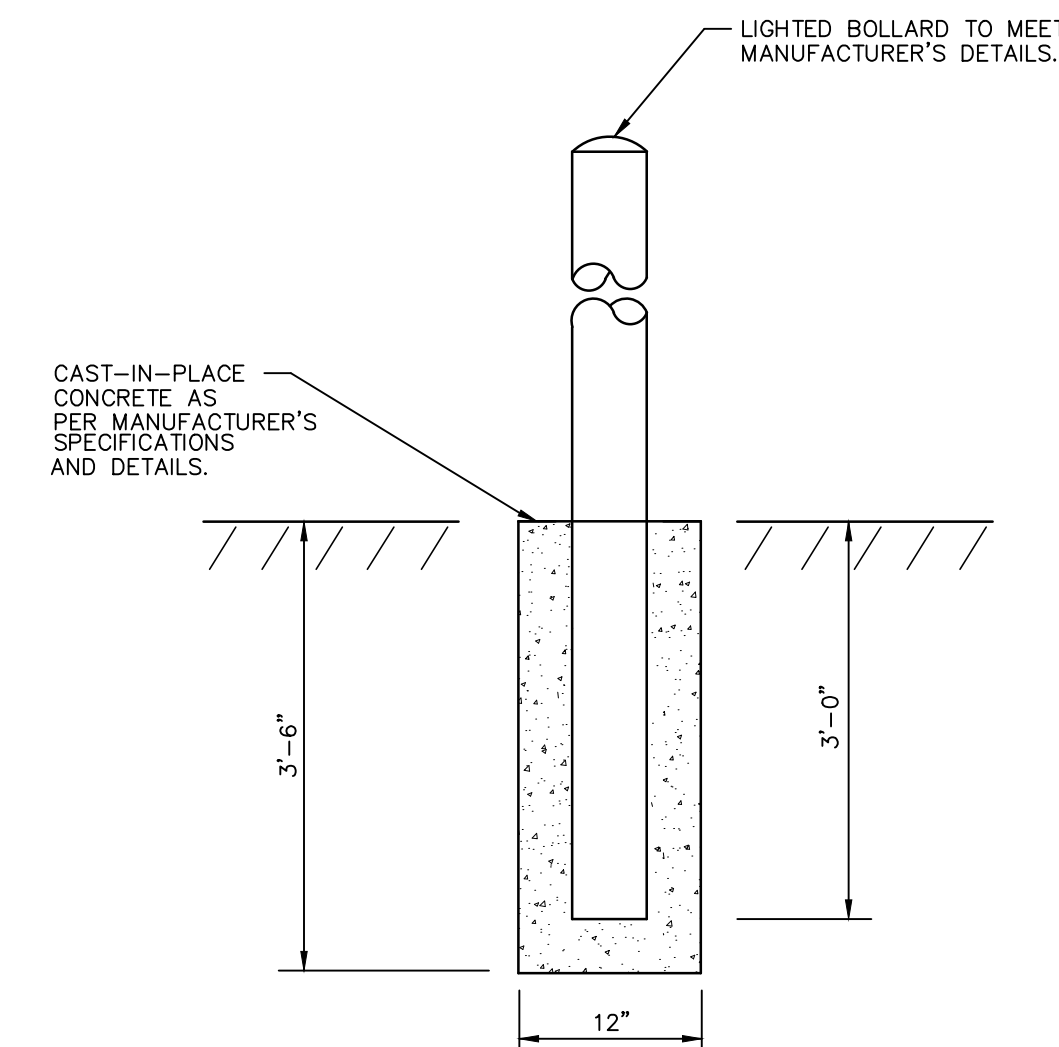

BOLLARD DETAIL

N.T.S.

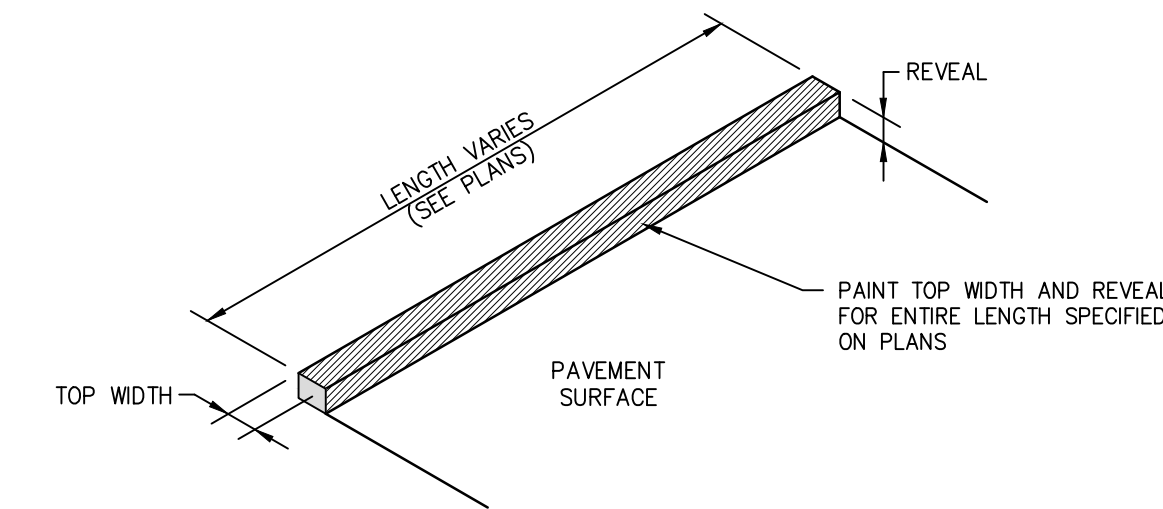

CURB PAINTING DETAIL

N.T.S.

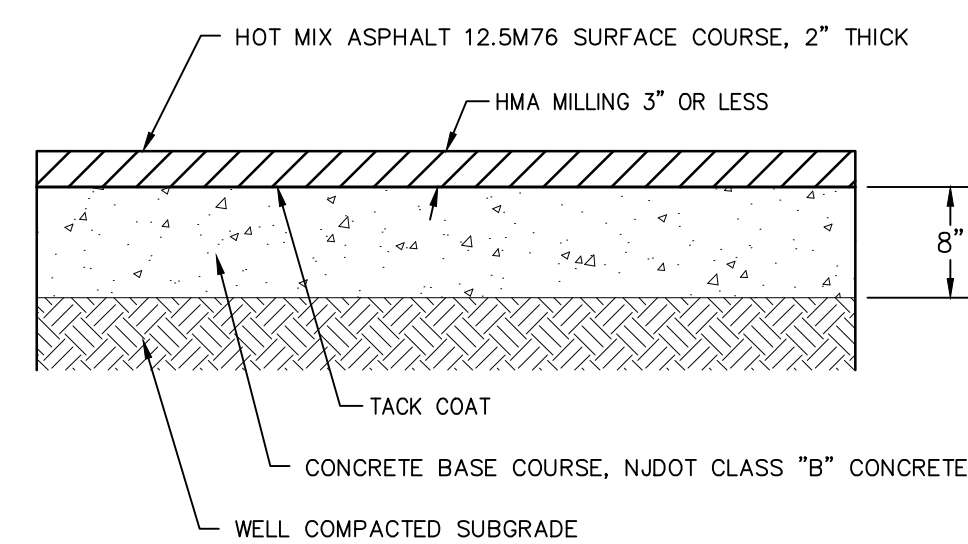

NOTES:

1. DEPTH OF MILLING SHALL BE 3" OR LESS IN ORDER TO MILL EXISTING PAVEMENT DOWN TO THE CONCRETE BASE COURSE. IT IS ANTICIPATED THERE IS ABOUT 2" OF ASPHALT EXISTING.
2. EXISTING CONCRETE BASE SHALL NOT BE DISTURBED THROUGH MILLING.
3. TACK COAT SHALL BE INSTALLED OVER CONCRETE BASE COURSE PRIOR TO INSTALLATION OF HOT MIX ASPHALT SURFACE COURSE. SO SEPARATE PAYMENT WILL BE MADE.

TYPICAL FINAL PAVING SECTION WITH CONCRETE BASE

N.T.S.

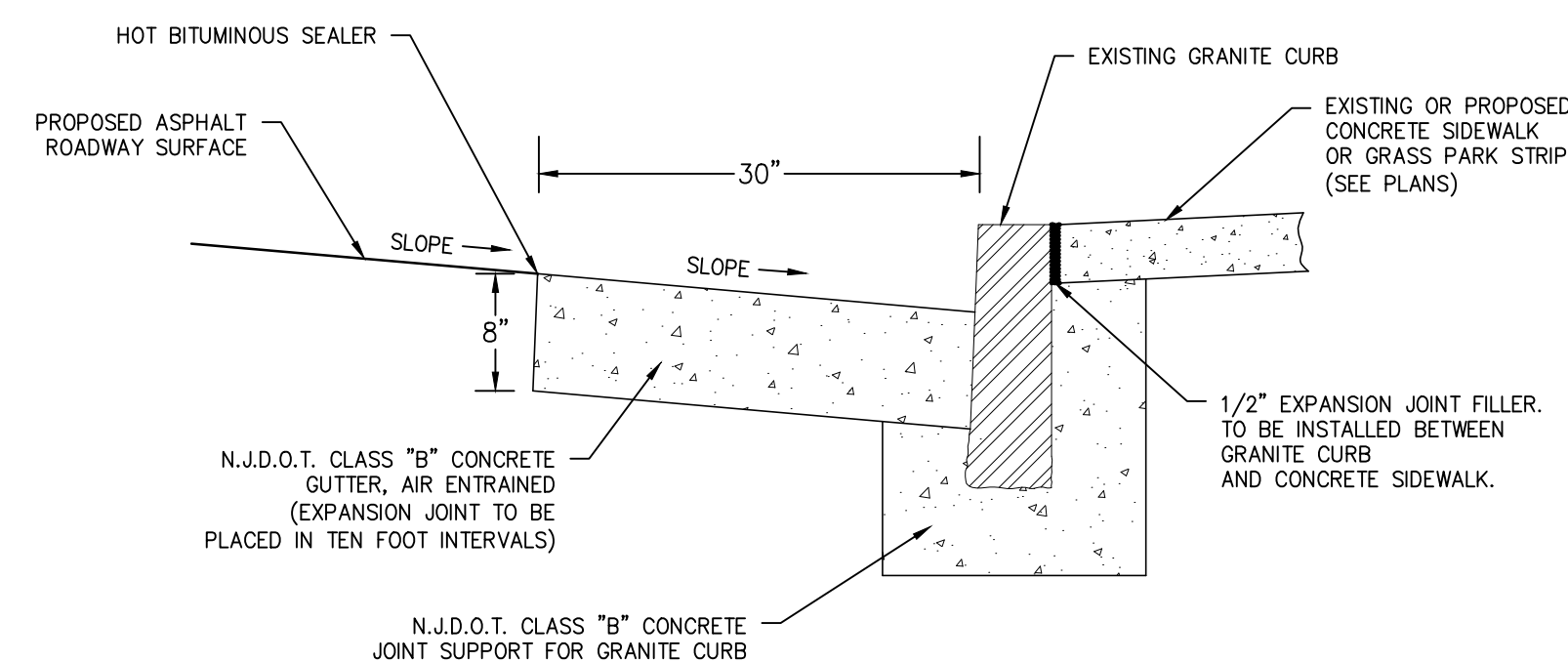

NOTES:

1. CONCRETE JOINT SUPPORT FOR GRANITE CURB DETAIL TO BE USED FOR RESETTING EXISTING GRANITE CURB.
2. A 1'-6" X 1'-6" CONCRETE JOINT SUPPORT, AS SPECIFIED IN THIS DETAIL, IS TO BE CONSTRUCTED AT EACH GRANITE CURB JOINT THAT IS REQUIRED TO BE RESET.
3. NO SEPARATE PAYMENT WILL BE MADE FOR REMOVAL OF EXISTING CONCRETE JOINT SUPPORT OR THE INSTALLATION OF NEW CONCRETE JOINT SUPPORT. COST SHALL BE INCLUDED IN THE PRICE BIDS FOR GRANITE CURB AND RESET EXISTING GRANITE CURB.

8" X 30" CONCRETE GUTTER WITH GRANITE CURB DETAIL

N.T.S.

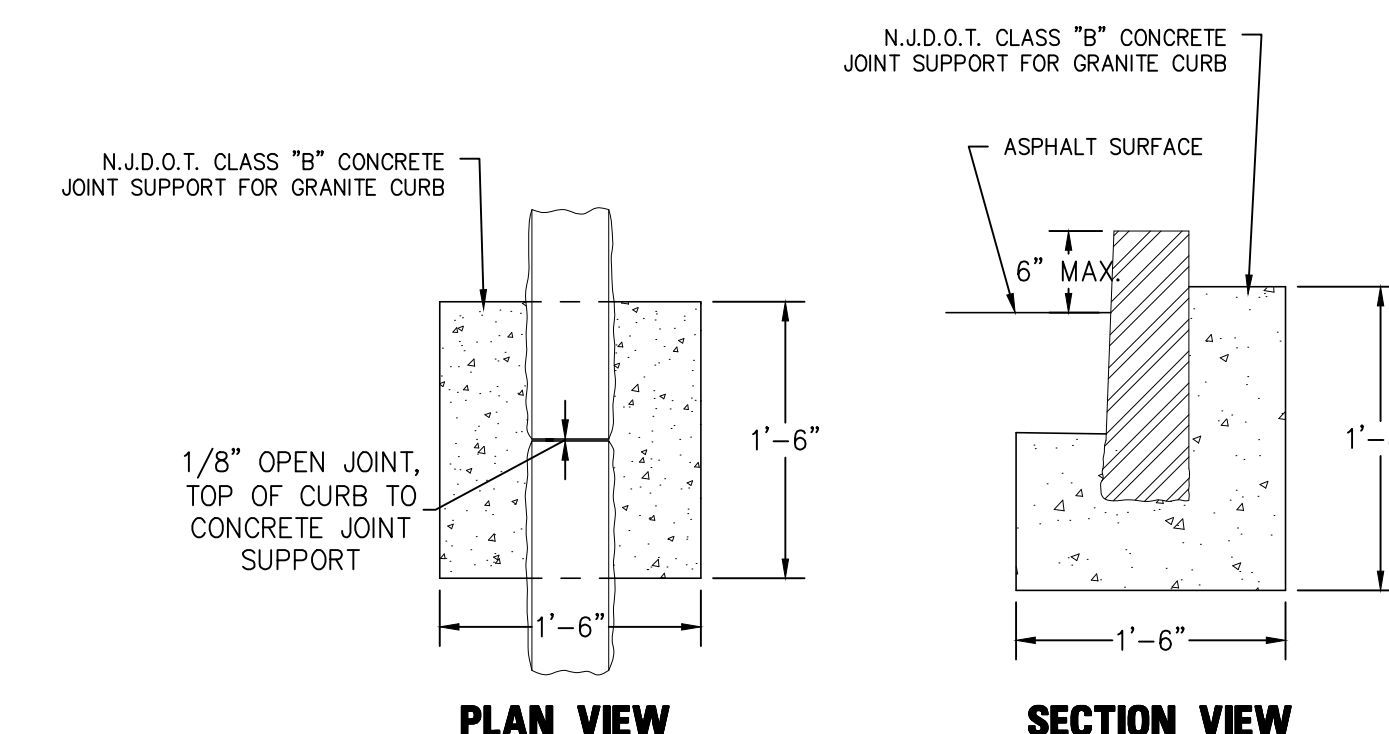

NOTES:

1. CONCRETE JOINT SUPPORT FOR GRANITE CURB DETAIL TO BE USED FOR RESETTING EXISTING GRANITE CURB.
2. A 1'-6" X 1'-6" CONCRETE JOINT SUPPORT, AS SPECIFIED IN THIS DETAIL, IS TO BE CONSTRUCTED AT EACH GRANITE CURB JOINT THAT IS REQUIRED TO BE RESET.
3. NO SEPARATE PAYMENT WILL BE MADE FOR REMOVAL OF EXISTING CONCRETE JOINT SUPPORT OR THE INSTALLATION OF NEW CONCRETE JOINT SUPPORT. COST SHALL BE INCLUDED IN THE PRICE BIDS FOR GRANITE CURB AND RESET EXISTING GRANITE CURB.
4. THIS DETAIL SHALL BE USED FOR CONSTRUCTING GRANITE CURB.

CONCRETE JOINT SUPPORT FOR GRANITE CURB DETAIL (GRANITE CURB / RESET EXISTING GRANITE CURB)

N.T.S.



REMINGTON & VERNICK ENGINEERS
 2819 FIRE ROAD, 1ST FLOOR
 EGG HARBOR TOWNSHIP, NJ 08234
 (609) 645-7110, FAX (609) 645-7076
 WEB ADDRESS : RVE.COM
 Certification of Authorization: 24 GA 28003300
Excellence • Innovation • Service

Nicholas R. DiCosmo
NICHOLAS R. DICOSMO
 NJ PROFESSIONAL ENGINEER LIC. No. 57899

Joseph H. Johnston
JOSEPH H. JOHNSTON
 NJ PROFESSIONAL ENGINEER LIC. No. 35729

PLANS WHICH DO NOT BEAR AN EMBOSSED SEAL OR DIGITAL SEAL ARE NOT VALID.
 ALL DOCUMENTS PREPARED BY REMINGTON & VERNICK ENGINEERS AND AFFILIATES ARE INSTRUMENTS OF SERVICE IN RESPECT OF THE PROJECT. THEY ARE NOT INTENDED OR REPRESENTED TO BE SUITABLE FOR REUSE BY OWNER OR OTHERS ON EXTENSIONS OF THE PROJECT OR ON ANY OTHER PROJECT. ANY REUSE WITHOUT WRITTEN VERIFICATION OR ADAPTATION BY REMINGTON & VERNICK ENGINEERS AND AFFILIATES FOR THE SPECIFIC PURPOSE INTENDED WILL BE AT OWNERS SOLE RISK AND WITHOUT LIABILITY OR LEGAL EXPOSURE TO REMINGTON & VERNICK ENGINEERS AND AFFILIATES. AND OWNER SHALL INDEMNIFY AND HOLD HARMLESS REMINGTON & VERNICK ENGINEERS AND AFFILIATES FROM ALL CLAIMS, DAMAGES, LOSSES AND EXPENSES ARISING OUT OF OR RESULTING THEREFROM.

NO.	REVISION	DATE	BY/CHK

CONSTRUCTION DETAILS
 GLOBAL SPECTRUM L.P.
 CONVENTION BOULEVARD RESURFACING
 CITY OF ATLANTIC CITY
 ATLANTIC COUNTY
 NEW JERSEY

DRAWN BY:	DESIGN BY:	CHECKED BY:	SCALE:
DW	N.R.D.	J.E.J.	AS NOTED
DATE:	SHEET No.:		
9/4/2025	7 of 10		
JOB No.:	60-37-J-001		

PERMANENT VEGETATIVE MIXTURES, PLANTING RATES AND PLANTING DATES ¹												
SEED MIXTURE ²	PLANTING RATE ³		PLANTING DATES								MAINTENANCE LEVEL ⁴	REMARKS
			O = Optimal Planting period				A = Acceptable Planting period					
			PLANT HARDINESS ZONES (see Map)									
lbs/acre	lbs/1000 sq. ft.	Zone 5b, 6a		Zone 6b		Zone 7a, 7b						
		3/15-5/31	6/1-7/31	8/1-10/1	3/1-4/30	5/1-8/14	8/15-10/15	2/1-4/30	5/1-8/14	8/15-10/30		
WARM SEASON SEED MIXTURES												
1A. For Pinelands National Reserve Seed mixtures see Table 4-4 page 4-17												
1. Switchgrass and/or Coastal Panicgrass plus or Flutpea	15	0.35									C-D	
2. Deertongue or Switchgrass Redtop	15	0.35									C-D	Use Deertongue if pH < 4.0. Switchgrass is superior wildlife plant. Use for waterways. Redtop provides quick cover.
3. Switchgrass Deertongue Little Bluestem Sheep Fescue plus Partridge Pea	15	0.35									C-D	Pinelands mixture.
4. Switchgrass Big Bluestem Little Bluestem Sand Lovegrass Coastal Panicgrass	10	0.25									C-D	Native warm-season mixture.
5. Bermudagrass Zoysagrass (seed) Zoysagrass (sprigs)	15	0.35									A-D	Bermudagrass has superior salt tolerance. Zoysa has greater wear tolerance.
COOL SEASON SEED MIXTURES												
6. Fine Fescue (Blend) Hard Fescue Cheatings Fescue Strong Creeping Red Fescue Kentucky Bluegrass Perennial Ryegrass plus White Clover (see note at right)	130	3									B-D	General low-maintenance mixture. White clover can be removed when used to establish lawns.
7. Strong Creeping Red Fescue Kentucky Bluegrass Perennial Ryegrass or Redtop plus White clover	130	3									B-D	Suitable waterway mix. Canada Bluegrass more drought tolerant. Use Redtop for increased drought-tolerance.
8. Tall fescue (turf-type) or Strong Creeping Red Fescue or Perennial Ryegrass Flutpea	30	0.70									B-D	Tall Fescue best selected for droughty conditions. Use Creeping Red Fescue in heavy shade. Use Flutpea to suppress woody vegetation.
9. Deertongue Redtop Wild Rye (Elymus) Switchgrass	20	0.45									C-D	Native wet mix.
10. Tall fescue (turf-type) Perennial Ryegrass or White Clover	265	6									C-D	White clover can be excluded on lawn sites.
11. Kentucky Bluegrass Turf-type Tall Fescue	45	1									C-D	Filter strip use for nutrient uptake.
12. Turf-type Tall Fescue (Blend of 3 cultivars)	350	8									C-D	General lawn/recreation.
13. Hard Fescue and/or Cheating Fescue and/or Strong Creeping Red Fescue Perennial Ryegrass Kentucky Bluegrass (blend)	175	4									A-C	General lawn/recreation.
14. Tall Fescue Kentucky Bluegrass (blend) Perennial Ryegrass (blend)	265	6									A-B	Athletic field / 3 Cultivar mix of Kentucky Bluegrass.
15. Hard Fescue Cheatings Fescue Strong Creeping Red Fescue Perennial Ryegrass	130	3									C-D	Low-maintenance fine fescue lawn mix.
16. Rough Bluegrass Strong Creeping Red Fescue	90	2									C-D	Moist shade.
17. Creeping Bentgrass Creeping Red Fescue Alkali Saltgrass	45	1									B-D	Use bentgrass under wetter conditions. Saltgrass will only persist under saline conditions.
18. Hard or Sheep Fescue N.E. Wildflower Mixture	25	0.60									C-D	Regional Wildflower mix. Hydroseeding not recommended.
19. a. Smooth Cordgrass b. Saltmeadow Cordgrass	veg										D	Planted in the intertidal zone. Planted above mean high tide.
20. American Beachgrass Coastal Panicgrass	veg	0.45									D	Coastal Panicgrass may be interseeded between rows of beachgrass.
21. a. Purplestee Willow b. Dwarf Willow c. Redosier Dogwood d. Silky Dogwood	veg										D	Also refer to Chapters 16 and 18 of USDA NRCS Engineering Field Handbook.

- FOOTNOTES:**
- ALL NOTES REFERENCE "THE STANDARDS FOR SOIL EROSION AND SEDIMENT CONTROL IN NEW JERSEY, 7TH EDITION, JANUARY 2014, REVISED JULY 2017," PUBLISHED BY THE NEW JERSEY DEPARTMENT OF AGRICULTURE-STATE SOIL CONSERVATION COMMITTEE.
 - SEE APPENDIX B FOR DESCRIPTIONS OF TURF GRASS MIXTURES AND CULTIVARS. THE ACTUAL AMOUNT OF WARM-SEASON GRASS MIXTURE USED IN TABLE 3 (SEED MIX 1-7) SHALL BE ADJUSTED TO REFLECT THE AMOUNT OF PLS AS DETERMINED BY GERMINATION TESTING RESULTS. NO ADJUSTMENT IS REQUIRED FOR COOL-SEASON GRASSES (SEE MIXTURES 8-20).
 - SEEDING MIXTURES AND/OR RATES NOT LISTED ABOVE MAY BE USED IF RECOMMENDED BY THE LOCAL SOIL CONSERVATION DISTRICT, NATURAL RESOURCES CONSERVATION SERVICE, RECOMMENDATIONS OF RUTGERS COOPERATIVE EXTENSION MAY BE USED IF APPROVED BY THE SOIL CONSERVATION DISTRICT. LEGUMES (WHITE CLOVER, FLUTPEA, LESPEDEZA) SHOULD BE MIXED WITH PROPER INOCULANT PRIOR TO PLANTING.
 - SEEDING RATES SPECIFIED ARE REQUIRED WHEN A REPORT OF COMPLIANCE IS REQUESTED PRIOR TO ACTUAL ESTABLISHMENT OF PERMANENT VEGETATION. UP TO 50% REDUCTION IN RATES MAY BE USED WHEN PERMANENT VEGETATION IS ESTABLISHED PRIOR TO A REPORT OF COMPLIANCE INSPECTION. THESE RATES APPLY TO ALL METHODS OF SEEDING. ESTABLISHING PERMANENT VEGETATION MEANS 80% VEGETATIVE COVERAGE OF THE SEEDING AREA AND MOWED ONCE. GRASS SEED MIXTURE CHECKED BY THE STATE SEED ANALYST, NEW JERSEY DEPARTMENT OF AGRICULTURE, TRENTON, NEW JERSEY, WILL ASSURE THE PURCHASER THAT THE MIXTURE OBTAINED IS THE MIXTURE ORDERED, PURSUANT TO THE N.J. STATE SEED LAW, N.J.S.A. 4:8-17.13 ET. SEQ.
 - MAINTENANCE LEVEL:
 - 5.A. INTENSIVE MOWING (2-4 DAYS), FERTILIZATION, LIME, PEST CONTROL AND IRRIGATION (EXAMPLES - HIGH-MAINTENANCE LAWNS, COMMERCIAL AND RECREATION AREAS, PUBLIC FACILITIES).
 - 5.B. FREQUENT MOWING (4-7 DAYS), OCCASIONAL FERTILIZATION, LIME AND WEED CONTROL (EXAMPLES - HOME LAWNS, COMMERCIAL SITES, SCHOOL SITES).
 - 5.C. PERIODIC MOWING (7-14 DAYS), OCCASIONAL FERTILIZATION AND LIME (EXAMPLES - HOME LAWNS, PARKS).
 - 5.D. INFREQUENT OR NO MOWING, FERTILIZATION AND LIME THE FIRST YEAR OF ESTABLISHMENT (EXAMPLES - ROADSIDES, RECREATION AREAS, PUBLIC OPEN SPACES)
 - SUMMER SEEDINGS SHOULD ONLY BE CONDUCTED WHEN THE SITE IS IRRIGATED. MIXES INCLUDING WHITE CLOVER REQUIRE THAT AT LEAST SIX WEEKS OF GROWING SEASON REMAIN AFTER SEEDING TO ENSURE ESTABLISHMENT BEFORE FREEZING CONDITIONS.

O = OPTIMAL PLANTING PERIOD A = ACCEPTABLE PLANTING PERIOD

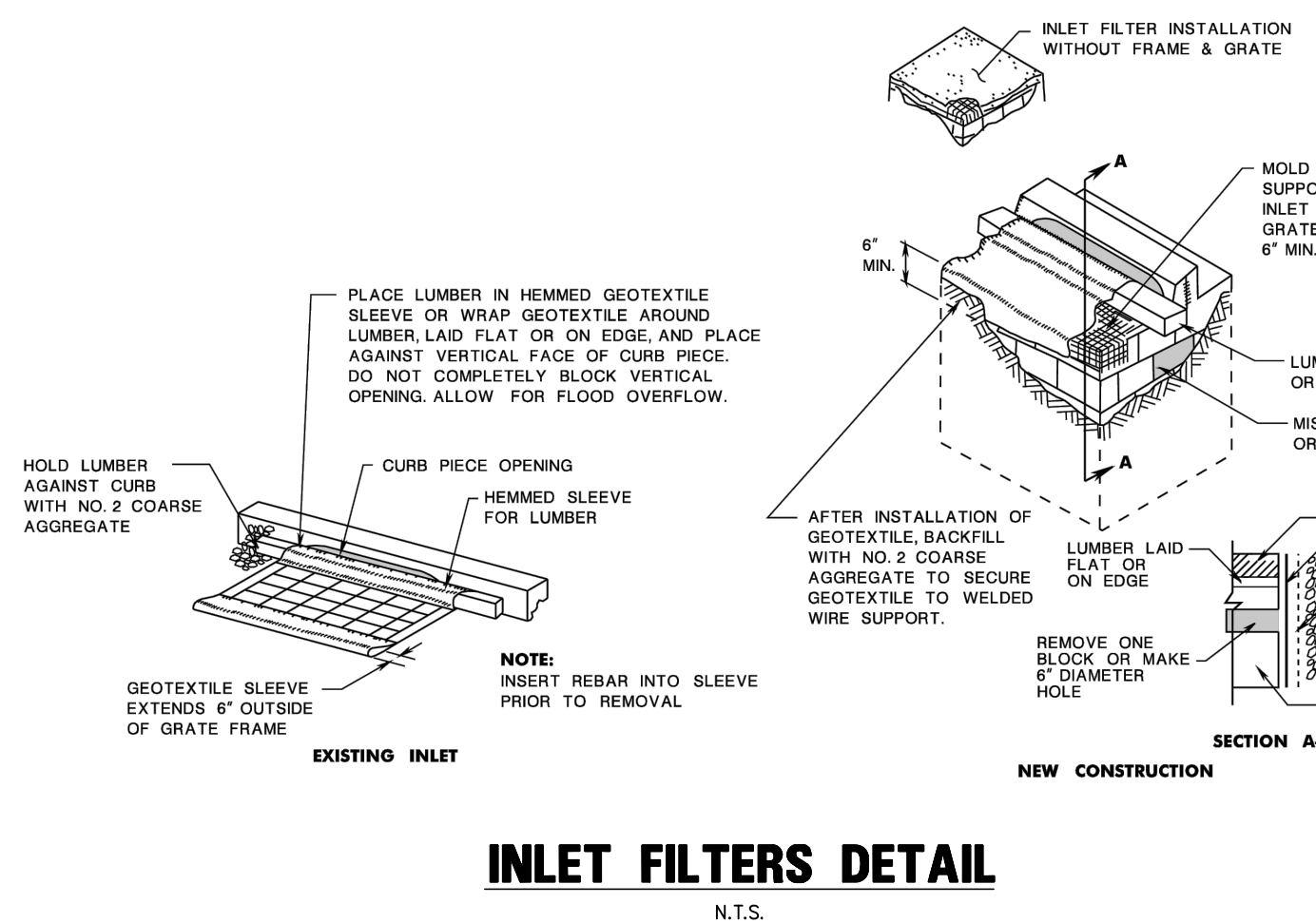
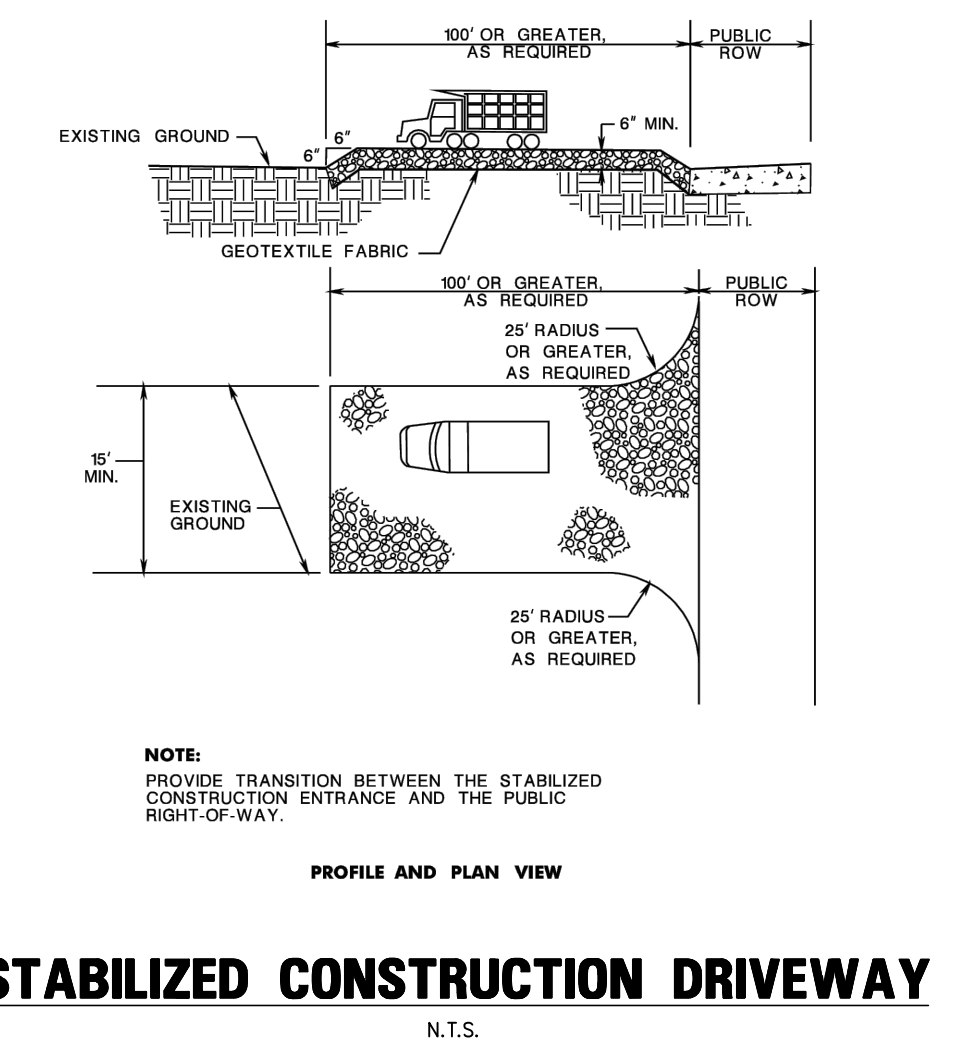
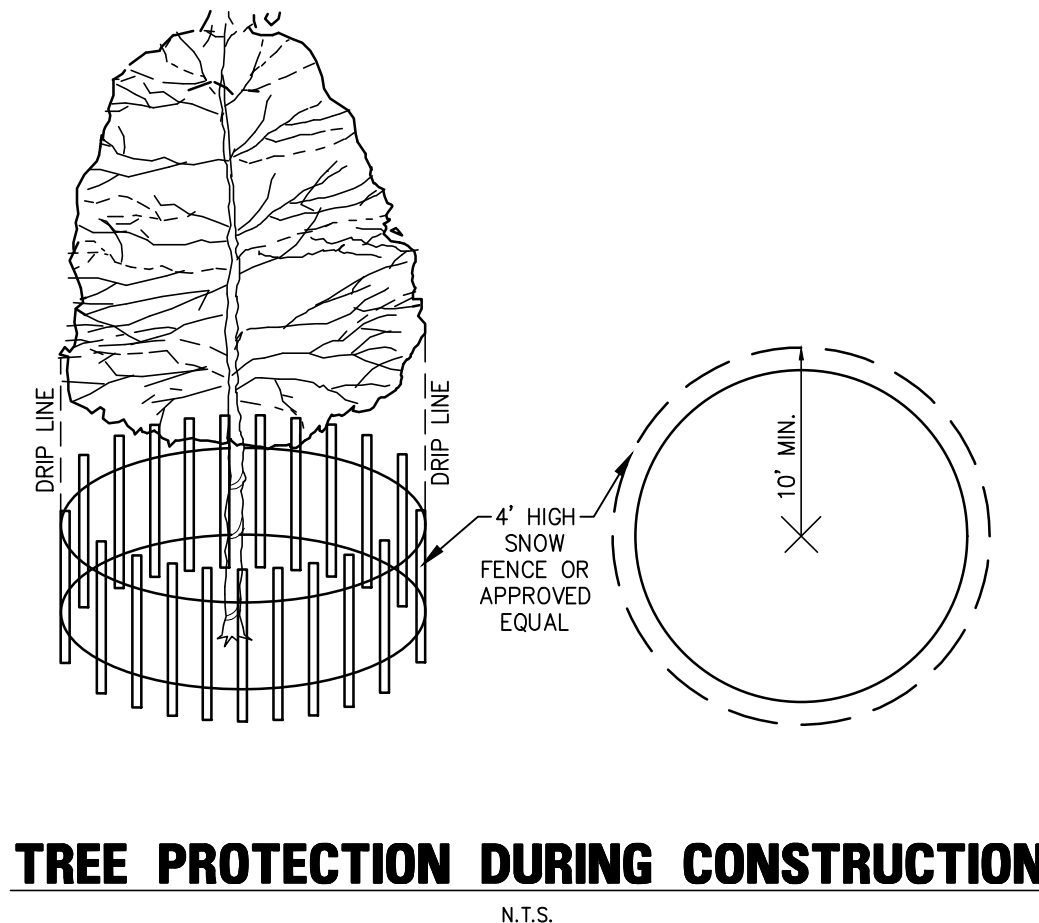
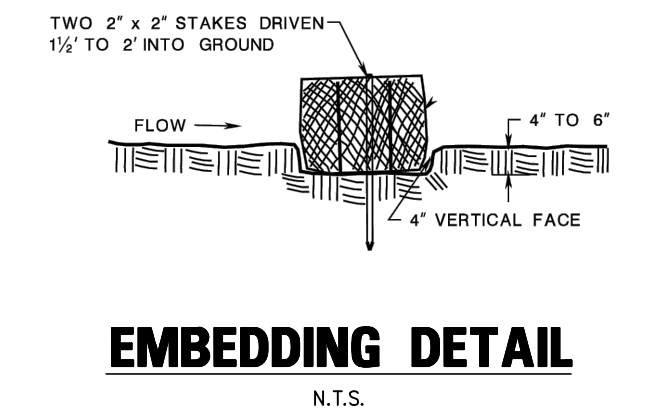
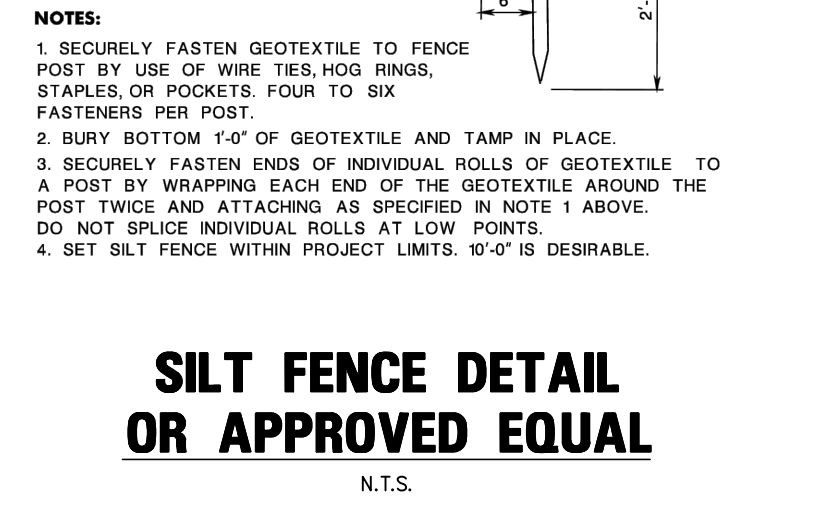
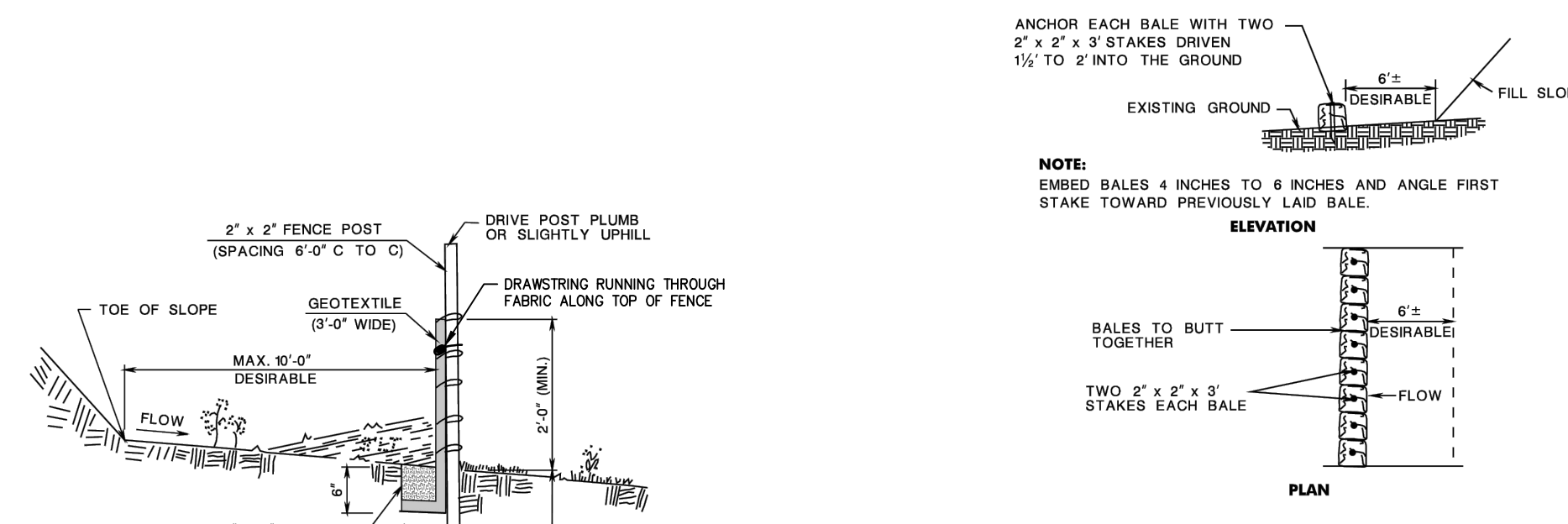
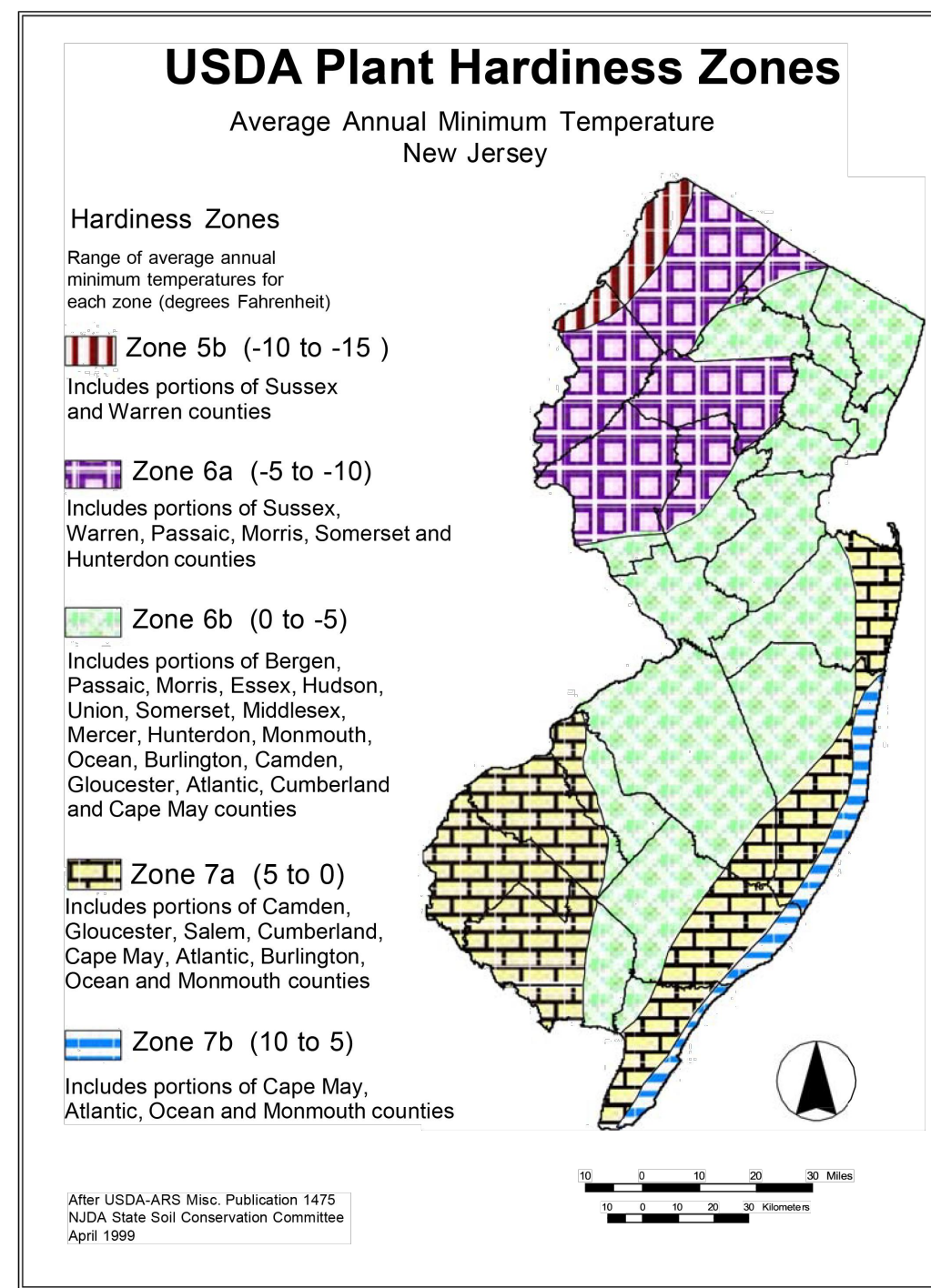

REMINGTON & VERNICK ENGINEERS
2819 FIRE ROAD, 1ST FLOOR
EGG HARBOR TOWNSHIP, NJ 08234
(609) 645-7110, FAX (609) 645-7076
WEB ADDRESS: RVE.COM
Certification of Authorization: 24 GA 28003300
Excellence • Innovation • Service

NICHOLAS R. DICOSMO
NJ PROFESSIONAL ENGINEER LIC. No. 57899

JAMES H. JACOBSON
NJ PROFESSIONAL ENGINEER LIC. No. 35729

PLANS WHICH DO NOT BEAR AN EMBOSSED SEAL OR DIGITAL SEAL ARE NOT VALID.

ALL DOCUMENTS PREPARED BY REMINGTON & VERNICK ENGINEERS AND AFFILIATES ARE INSTRUMENTS OF SERVICE IN RESPECT OF THE PROJECT. THEY ARE NOT INTENDED OR REPRESENTED TO BE SUITABLE FOR REUSE BY OWNER OR OTHERS ON EXTENSIONS OF THE PROJECT OR ON ANY OTHER PROJECT. ANY REUSE WITHOUT WRITTEN VERIFICATION OR ADAPTATION BY REMINGTON & VERNICK ENGINEERS AND AFFILIATES FOR THE SPECIFIC PURPOSE INTENDED WILL BE AT OWNERS SOLE RISK AND WITHOUT LIABILITY OR LEGAL EXPOSURE TO REMINGTON & VERNICK ENGINEERS AND AFFILIATES. OWNER SHALL INDEMNIFY AND HOLD HARMLESS REMINGTON & VERNICK ENGINEERS AND AFFILIATES FROM ALL CLAIMS, DAMAGES, LOSSES AND EXPENSES ARISING OUT OF OR RESULTING THEREFROM.

	BY: <i>CHK</i>
	DATE: _____
	REVISION: _____

SOIL EROSION & SEDIMENT CONTROL DETAILS

GLOBAL SPECTRUM L.P.
CONVENTION BOULEVARD RESURFACING
CITY OF ATLANTIC CITY
ATLANTIC COUNTY
NEW JERSEY

DRAWN BY: DW	DESIGN BY: N.R.D.	CHECKED BY: J.E.J.	SCALE: AS NOTED
DATE: 9/4/2025			
JOB No.: _____			
60-37-J-001			

THIS PLAN TO BE USED FOR SOIL EROSION AND SEDIMENT CONTROL PURPOSES ONLY

9 of 10

