

*Boardwalk Hall*

YOUR BEST SEAT AT THE SHORE

# ADRIAN PHILLIPS THEATER

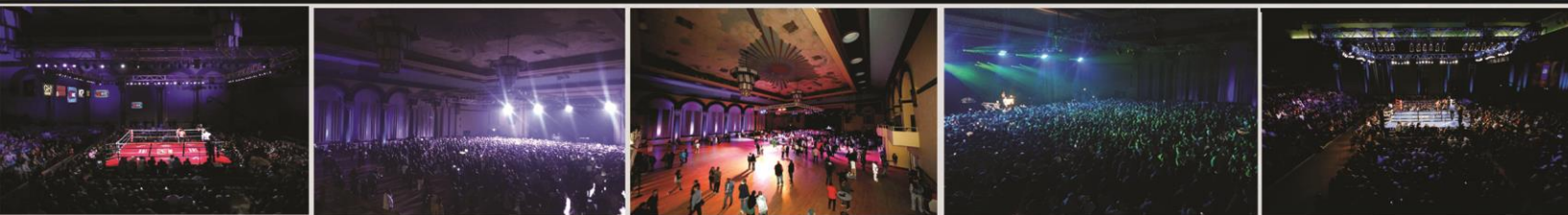

**SPECTRA**  
BY COMCAST SPECTACOR

## ADRIAN PHILLIPS THEATER INFORMATION AND SPECS

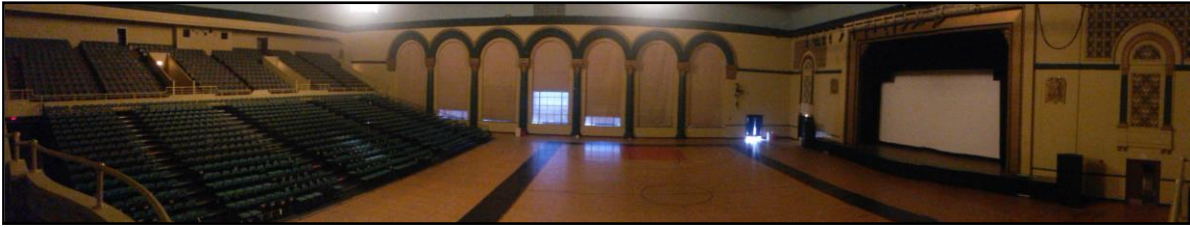

The Adrian Phillips Theater is located on the concourse level of Boardwalk Hall and can stretch upwards to 17,800 square feet of functional event space. The Theater features a distinct house stage with a 48' proscenium opening and an open air loggia which overlooks the famous Atlantic City boardwalk. The Theater is capable of accommodating a variety of events with capacities ranging from 1,000 for catered functions up to 3,000 for concerts and boxing events.

### THEATER PRODUCTION INFORMATION

#### Meeting Rooms

- Room 320 – 41' x 65' (Behind Upper Balcony)
- Room 321 – 42' x 58' (Behind Upper Balcony)

#### Dressing/Production Offices/Back of House Rooms

##### Backstage Rooms (Event Level)

- Room 208 – 24' x 13'
- Room 209 – 22' x 27'
- Room 210 – 22' x 39'

##### Backstage (2<sup>nd</sup> Level) w/(2) private bathrooms

- Bob H 1 – 13' x 20'
- Bob H 2 – 13' x 8'
- Bob H 3 – 13' x 8'
- Bob H 4 – 13' x 8'

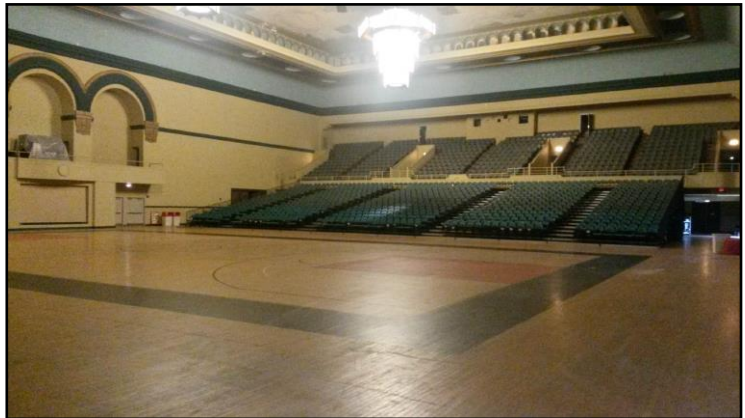

#### Electrical Power

The house stage is equipped with 800 amps of 208/3 phase power stage right and stage left.

Location	Number	Amp	Phase	Voltage	Connection
Stage Right	1	100	3	208	Wire tails disconnect
Stage Right	1	400	3	208	Wire tails disconnect
Stage Left	1	400	3	208	Wire tails disconnect
Stage Left	1	200	3	208	Wire tails disconnect



Stage Left	1	100	3	208	Wire tails disconnect
Stage Left	8	60	3	208	4 wire twist lock hub
Stage Left	1	20	1	120	Duplex Outlet

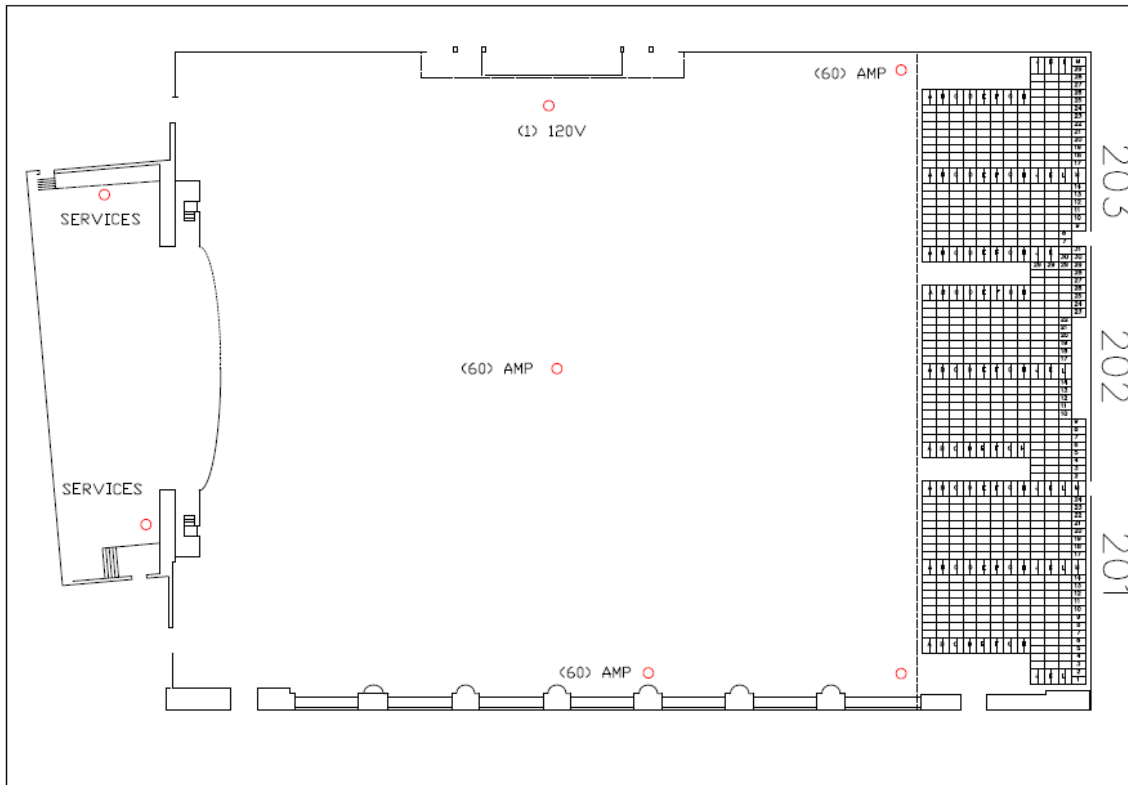

### **Telecommunications**

ISDN line is available through the stage right corridor. Hardline internet is limited to the stage side of the Theater and underneath the permanent balcony (Section 201 – 203). All meeting rooms can be hardwired with internet and the house wireless network is available in all event spaces. Additionally, Boardwalk Hall owns twelve (12) headsets and belt packs for com in the Theater. House com for the room is split into two channels.

### **Freight Elevators**

- Southeast Freight (Miss. Ave.) – 11'8" x 11'8" x 9'4" – 10,000lb capacity
- Southwest Freight (Georgia Ave.)– 11'8" x 11'8" x 9'4" – 10,000lb capacity

### **Audio Systems**

The Theater's audio system was recently upgraded with professional JBL gear for rider friendly operations. The state of the art arrays are complimented by fresh subwoofers, stage monitors, mic kits, and a new front fill system. A Yamaha LS9 console is conveniently located in the organ balcony for control and all speaker and amplifier systems are compatible with Performance Manager Sound system software. The house sound board (Yamaha LS9) can be moved to the center of the floor for a traditional FOH setup.



Below is a listing of the new sound equipment available inside the theater. Detailed listing is located in the appendix.

QTY	Model	Description	Location
20	JBL VTX-V25	Large Format Line Array	SR & SL (Rigged)
6	JBL VT4886	Small Format Line Array	Center Cluster (Rigged)
8	JBL VTX-G28	Dual 18" Subwoofers	Groundstacked
6	JBL AC18/26	Compact 8 inch two-way speaker system	Front Fills
4	JBL VTX-F12	F-Series Monitor two-way 12" woofer	Monitor Wedges
2	JBL VTX-F18S	F-Series Single 18" Subwoofer	Stage Monitors

#### **Audio Rig**

Stage Right & Stage Left line arrays are rigged 32' off the center line flush w/ the downstage edge of the permanent stage.

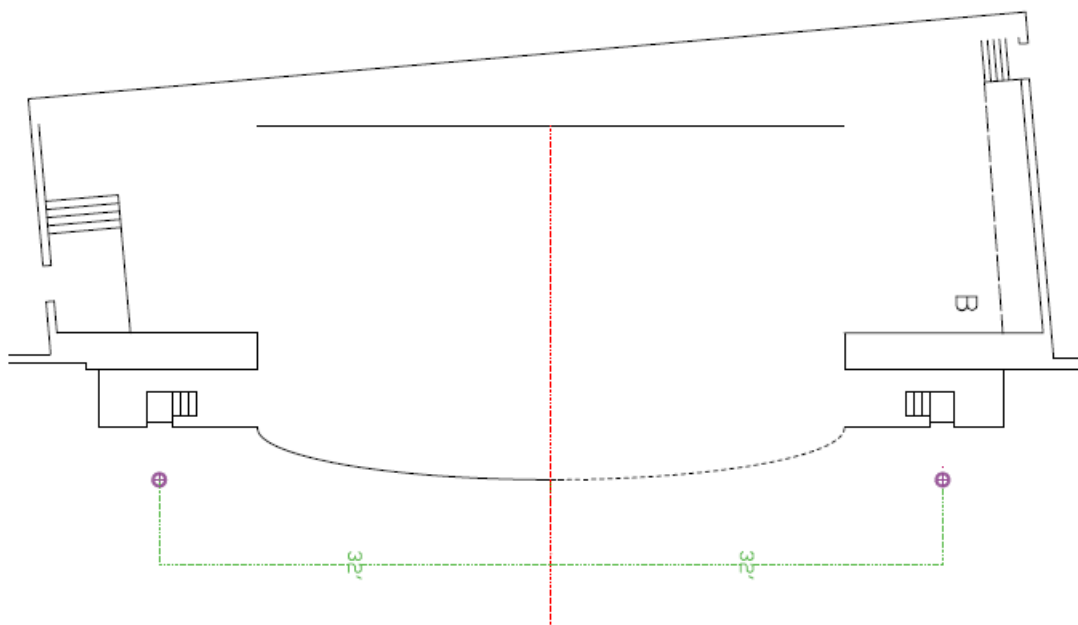

## Lighting Systems

Likewise, a new lighting package was installed in the Theater for rider acceptable conditions. The LED fixtures provide concert level lighting and can easily support lighting effects supplied by promoters. All fixtures are LED's and RGBW. The house control console is an AVO Pearl 2008 w/ four (4) DMX universes – a visiting console can output ARTNET or DMX into the console. Similar to the house audio board, the AVO Pearl can be moved to the floor for FOH.

Fixtures:

- (96) – Chauvet Colorado 1 Quad Zoom Tour (Pars)
- (16) – Martin Rush MH1+ Moving Head Profile spots (Movers)
- (16) – Altman Phoenix RGBW LED ellipsoidal spotlights (Lekos)
- (7) – Spectra CYC RGBA (Uplights)
- (4) – Elation Cuepix Panels (Audience Blinders)

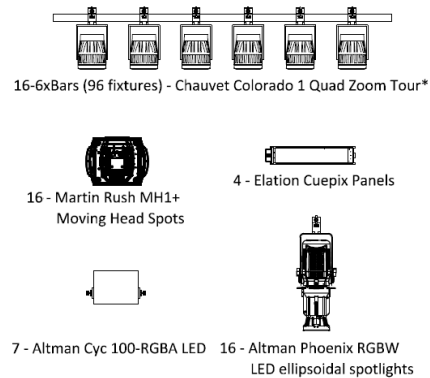

## Current Lighting Plot

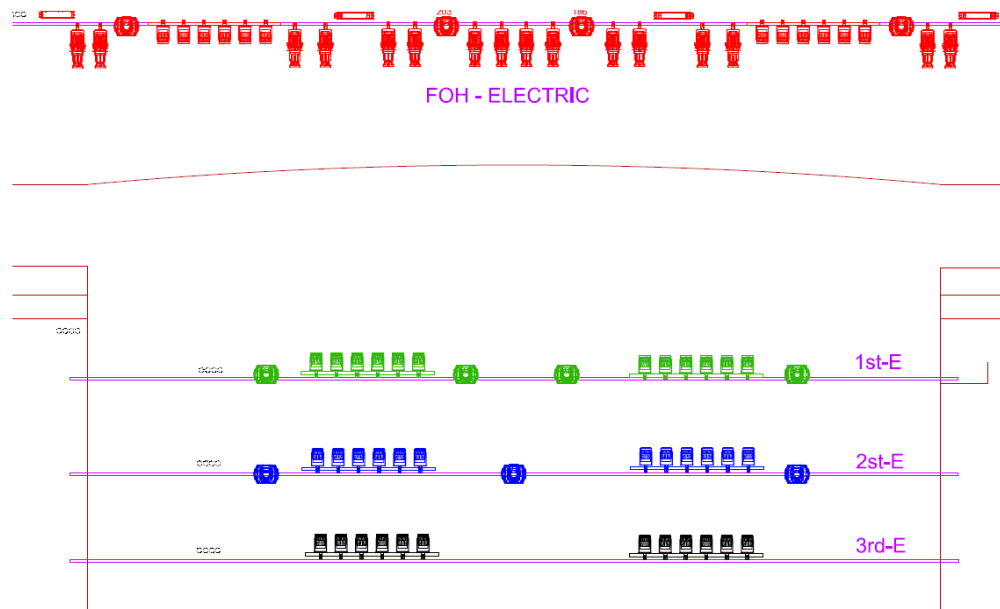

Detailed listing of the lighting equipment is located in the appendix.

## Theater Grid

Adrian Phillips houses a traditional theater grid inside the proscenium at a 71' x 15'3" footprint. The steel is 3" in width and runs upstage to downstage w/ 3" spacing in between (6" centers). 5' steel I-beams are rented to distribute load and to allow rigging in anywhere within the grid.

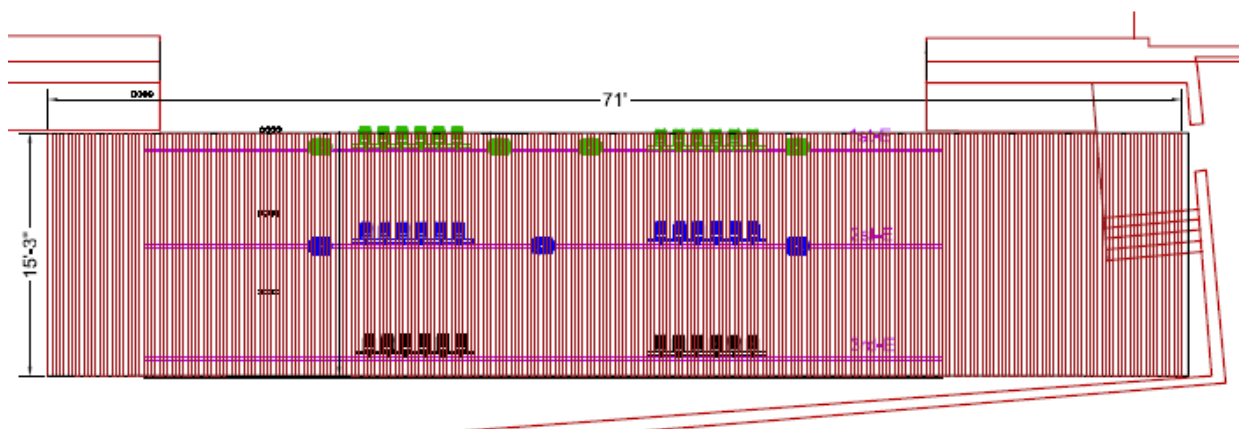

Additionally, line sets can be used for rigging inside the proscenium. Approx. 30 are in working condition.

### **Video Systems**

The Theater possesses a 40'w x 20'h video screen rigged inside the proscenium. Front projection is sourced from the projectors booth above the balcony seating. Throw is 185' from downstage center. The video screen can alternatively function as an upstage cyc as the screen is rigged just in front of the back wall.



### **Seating Capacity**

Seating capacity is contingent upon production requirements. Below are our basic capacities:

Balcony (Upper Level)	641
Riser (Temporary)	950
Rounds	1,000
Classroom Style	1,326
GA (Open Floor)	2,500
Boxing	2,900
Theater Style	3,200



### **Spotlights**

The Theater has two (2) Lyceum Xenon 2000 watt Super Troupers, located in the projection room opposite the stage. Additional spot lights can be built in the seating areas with risers. There are (6) super troupers inside the arena that can be used for the theater.

### **Theater Dimensions**

Proscenium Width – 48'

Proscenium Height – 24'

Stage Depth – 29'

Plaster Line to Upstage Wall – 20'

Plaster Line to DSE – 9'

Stage Height – 40.5"

Roll Door (SR) - 9'10"w x 8'8" h

Theater Grid (From Deck) – 46'h

Front Valance (From Deck) – 18'h

Chandelier (From Floor) – 30'h

Ceiling (From Floor) -55'h

FOH Electric Trim (From Floor) – 32'h





## APPENDIX

### Stage Extension (Downstage)

- Boardwalk Hall is capable of building an additional 40'w x 12'd temporary stage off the permanent house stage. Stage extension is level with the permanent stage.
- Boardwalk Hall owns two stage stairs that lead from the Theater floor to the stage extension.

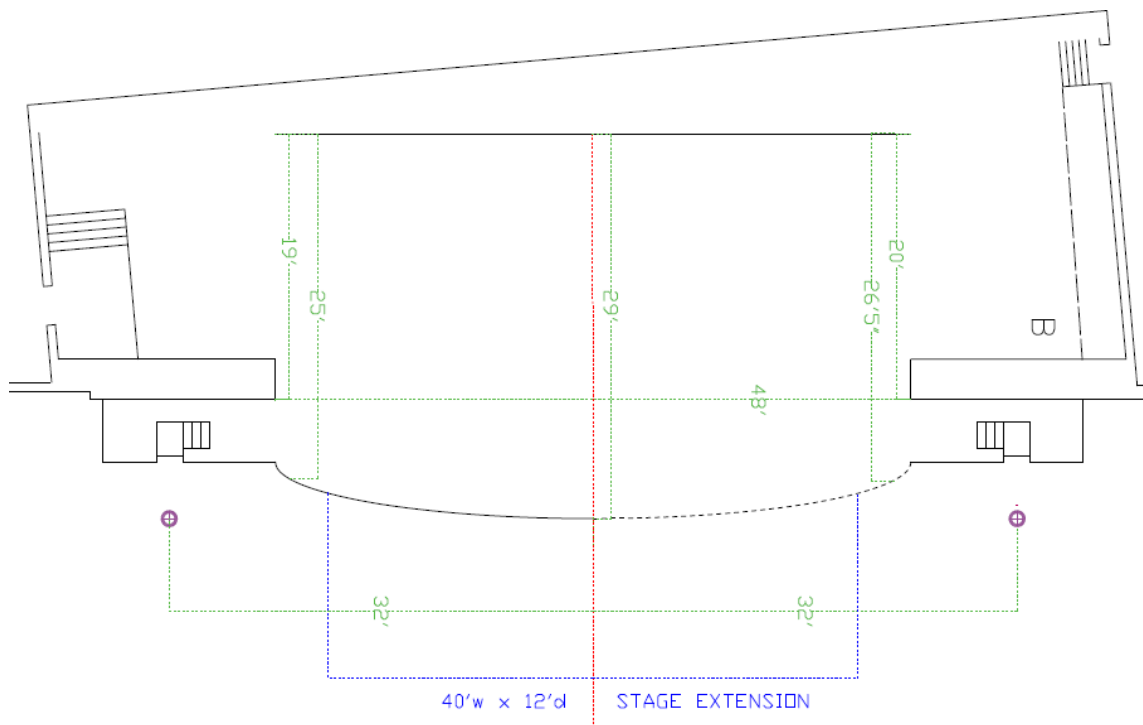



**Clear Floor (146' x 122')**

- Temporary riser can be removed for an open floor space of 17,800 sq. ft.

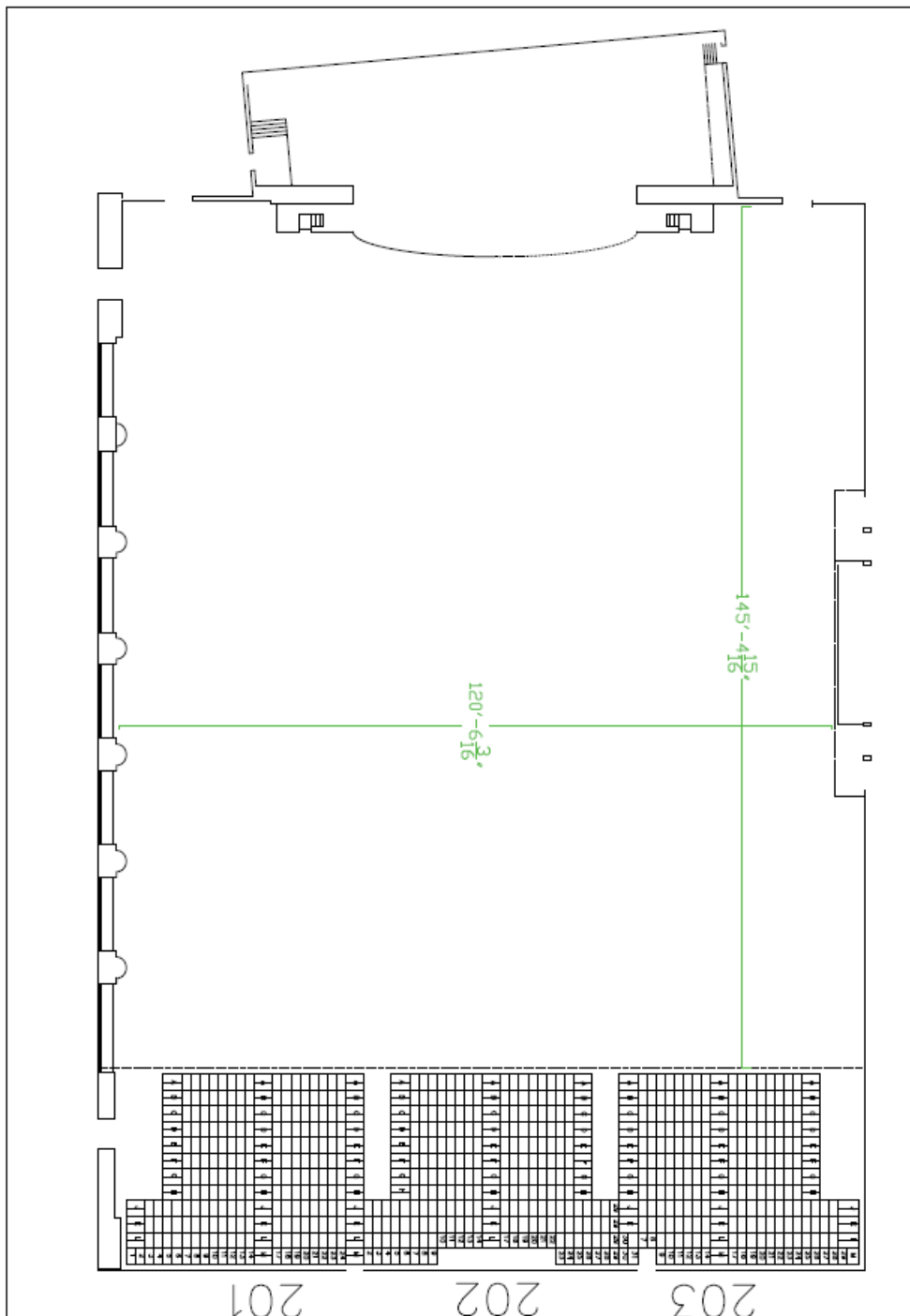

### **Boxing/MMA Rig**

- In-house trussing can be configured into a square box truss (40') or octagon for boxing and MMA events.
- The boxing/octagon rig is hung center house using the existing joists.

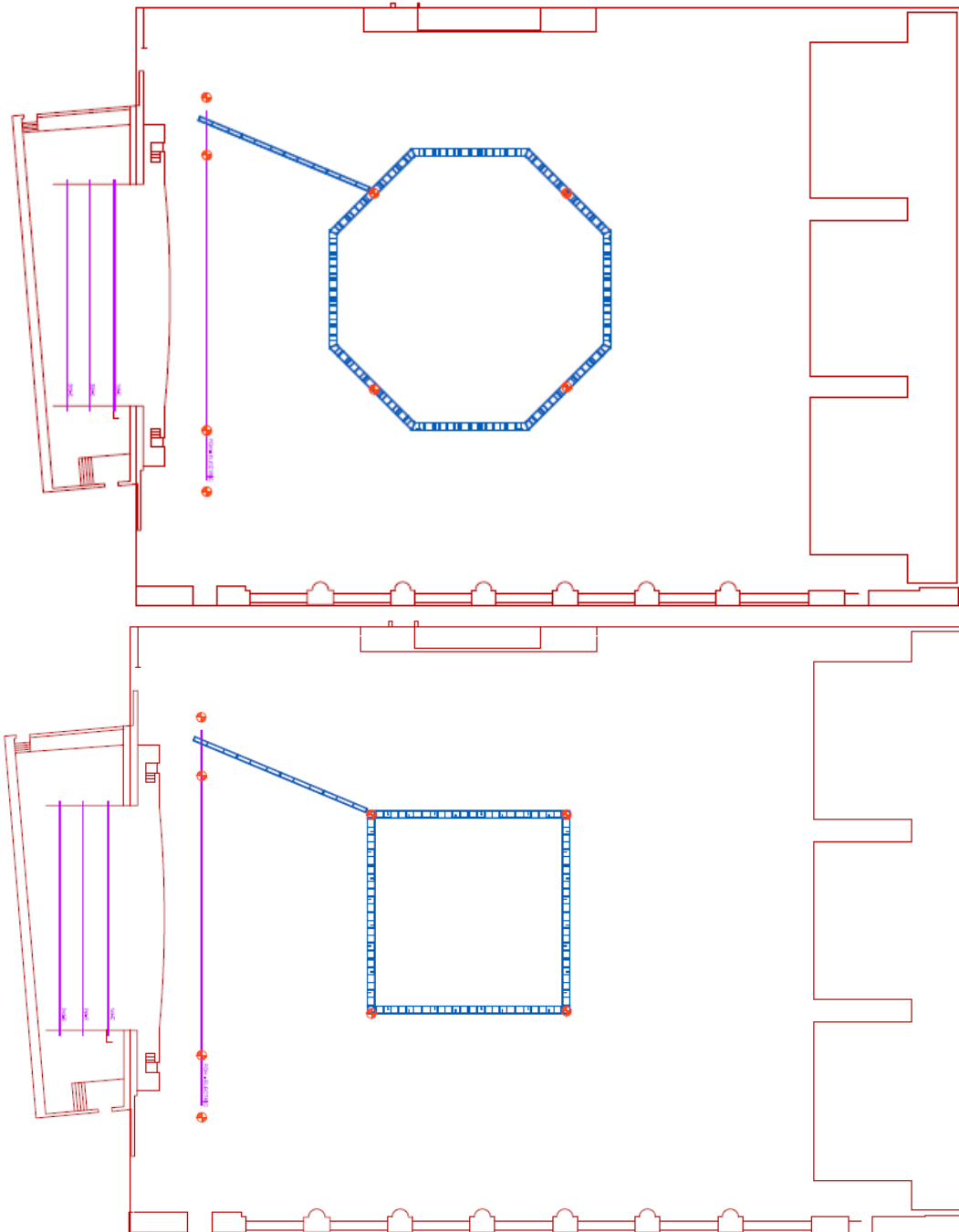

### **Detailed Audio Listing**

Main PA (max load is 268,000 watts):

- 10 JBL Vertec VTX V25 II per side (20 boxes total). Permanently Rigged (SR & SL).
- 6 JBL Vertec VT 4886 . Permanently rigged (center cluster).
- 4 JBL Vertec VTX-G28 Subs per side (8 total). Floor (SR & SL)
- 6 JBL AC18/2 Front Fills (On Deck)
- 10 Crown Itech 4x3400 HD
- 4 Crown Itech 12000 HD
- 1 Crown Itech 9000 HD
- 1 Crown Itech 5000 HD

Monitor System:

- 4 JBL VTX – F12 wedges
- 2 JBL STX 835 Side Fills
- 2 JBL VTX – F18s Subs
- 2 Crown Itech 4x3400 HD
- 1 Crown Itech 9000 HD
- 1 Crown Itech 5000 HD

System FOH Interface Capabilities:

- Yamaha LS9-32 with two Dante Cards
- Yamaha Rio 32 x 16 on stage
- Yamaha Rio 16 x 8 portable
- BSS London Routing system
  - Dante inputs
  - Analog road show inputs (L,R,C,Subs L&R, Frontfill, and Sides) Mix 1-4
- System auto mix for 2 RF microphones, 2 Lavs, and 4 wired microphones
- 6 Analog dry tie lines FOH to stage rack and 6 tie lines stage to booth
- 6 Fiber multi-mode dry lines FOH to stage and booth (ST connectors)
- 6 RG 6 dry tie lines FOH to stage and booth
- 2 each dedicated dry cat 6 And cat 6 shielded tie line FOH to stage and booth
- 4 Cat 6 network to patch bay FOH to stage
- 6 Cat 6 network from patch bay stage and booth
- Dedicated audio system wireless network

## **Detailed Lighting Listing**

### Trussing (XSF):

- 4 Corner squares (20" x 20" truss)
- 16 Grid truss at 10' per (20" x 20" truss)
- 8 Octagonal wedges (20" x 20" truss)
- Both rigs (box & octagon) are bridled on four one-ton motor points
- FOH electric is hung on four one-ton joists.
- Cable pick for FOH electric shares grid cable runoff.

### Fixtures:

- 7 Cyc lights SScyc100RBGWB (Altman)
- 16 Rush MH1 Profile + (Martin)
- 96 LED Pars Colorado 1 Quad Zoom (6 per lamp bar)
- 16 LED Iekos PHX2-RGBW19B (Altman)
- 16 B size gobo holders for Phoenix Ellipsoidals (Altman)
- 4 Cuepix blinders (Elation)
- House Console – AVO Pearl 2008 (can be placed organ balcony, rear center on the floor, and back stage)

### Electric:

- 1 Distro w/ volt & amp meters (Lex)
- All equipment is LED and operates on 120v (can operate on 220v)
- Portable power rack for box/octagon rig is 120v (8) and 208v (4) and 120v duplex (3), L6-20 (3) and L21-30(3)

### Cabling:

- 100 powercon/dmx jumpers w/ 1 lot of dmx cable

### Misc:

- 1 Enode 8 (Elation)
- 6 Enode 4 (FOH, 1<sup>st</sup> Electric, 2<sup>nd</sup> Electric, 3<sup>rd</sup> Electric, backstage, grid)
- 3 Show baby wireless dmx 1 channel transceivers

Lighting system provides 4 universes via artnet at all locations. All fixtures can be controlled individually with added channels available on each universe.



### Standard Theater Set

- Floor – 1,488 cap
- Section 101 – 105 (Bleachers) - 936 cap
- Section 201 – 203 (Upper Balcony) – 641 cap
- Total – 3,065

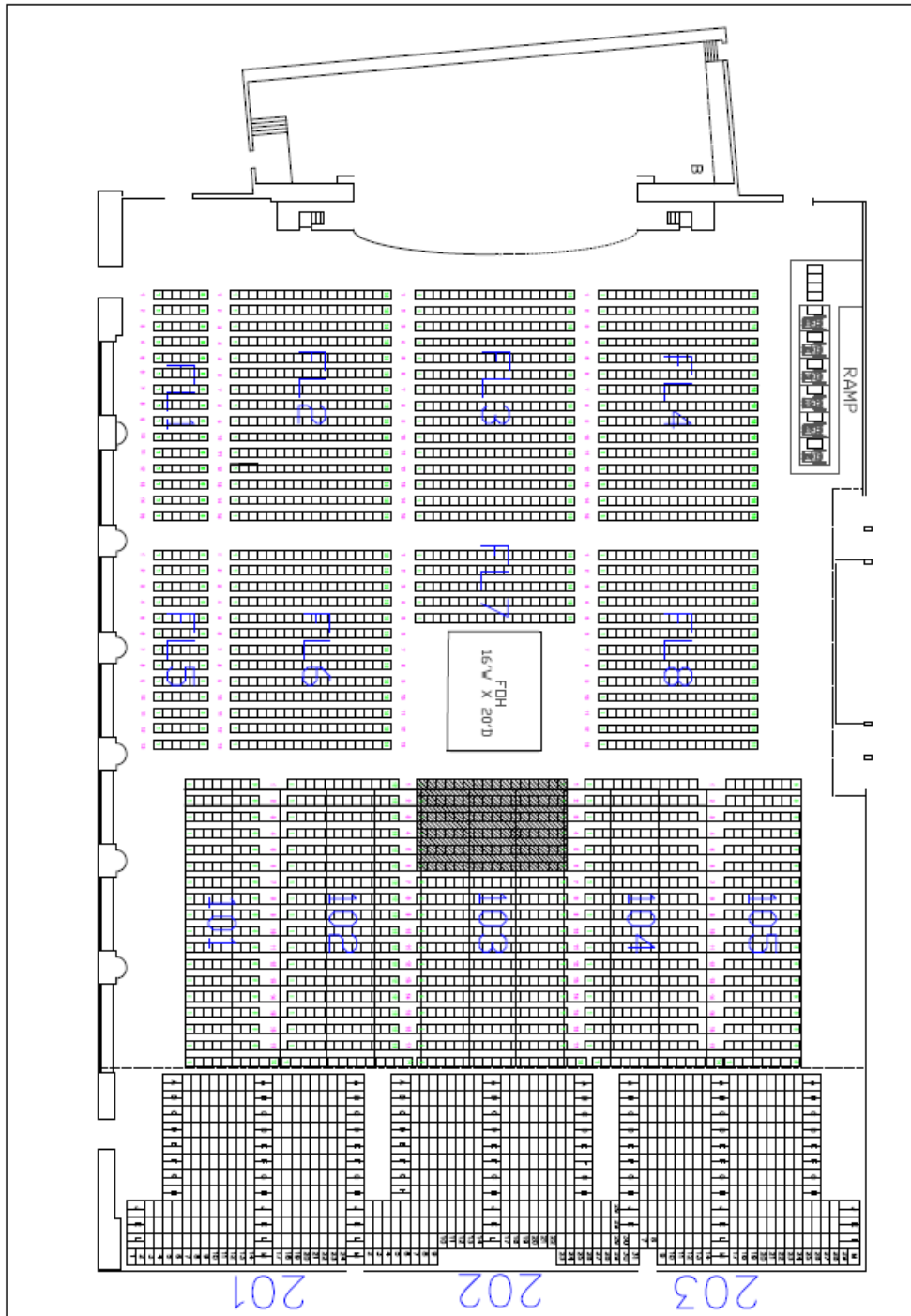

### Standard Theater Set With 12' Stage Extension

- Floor – 1,328
- Section 101 – 105 (Bleachers) - 936 cap
- Section 201 – 203 (Upper Balcony) – 641 cap
- Total – 2,905

