

GENERAL

- CONTRACTOR TO VERIFY EXISTING CONDITIONS AND DIMENSIONS AND SHALL REVIEW THE DRAWINGS AND SPECIFICATIONS PRIOR TO BIDDING. WORK SHALL BE PERFORMED IN ACCORDANCE WITH THESE PLANS AND THE SPECIFICATIONS, INCLUDING BUT NOT LIMITED TO THE FOLLOWING NOTES:
1. THE OWNER AND CONTRACTOR SHALL JOINTLY INSURE AND HOLD HARMLESS THE ENGINEER AND EACH OF HIS DIRECTORS, OFFICERS, EMPLOYEES, ATTORNEYS, AGENTS, SUBCONSULTANTS, HERES AND HIS AGENTS AND EMPLOYEES FROM AND AGAINST ALL DAMAGES, CLAIMS, CAUSES OF ACTION, COSTS AND EXPENSES, INCLUDING REASONABLE ATTORNEY'S FEES AND DISBURSEMENTS, SUFFERED OR INCURRED BY ANY OF THEM ARISING OUT OF, RESULTING FROM, ATTRIBUTABLE TO, OR IN ANY MANNER CONNECTED WITH THE CONTRACTOR'S PERFORMANCE, NONPERFORMANCE, NEGLIGENT PERFORMANCE, OR BREACH OF THE CONTRACT AGREEMENT.
2. CONTRACTOR MUST NOTIFY THE OWNER AND ENGINEER OF ANY OMISSIONS, CONTRADICTIONS OR CONFLICTS SEVEN DAYS BEFORE THE BID DATE. ENGINEER WILL PROVIDE THE NECESSARY CORRECTIONS AND A REVISION NOTICE TO THE BIDDING DOCUMENTS. IF THE ENGINEER HAS REVIEWED THE BIDDING DOCUMENTS AND HAS NOT ISSUED A REVISION, IT WILL BE CONSIDERED THAT ALL CONSTRUCTION SHALL BE IN ACCORDANCE WITH APPLICABLE LOCAL AND STATE REGULATIONS, BUILDING CODES, ORDINANCES AND GOOD CONSTRUCTION PRACTICES. IF THE CONTRACTOR FEELS A CONFLICT EXISTS BETWEEN THAT IS CONSIDERED GOOD CONSTRUCTION PRACTICE AND THESE PLANS, HE SHALL STATE IN WRITING ALL OBJECTIONS PRIOR TO SUBMITTING QUOTATIONS.
3. CONTRACTOR SHALL BE RESPONSIBLE FOR MAINTAINING THE STABILITY AND INTEGRITY OF EXISTING STRUCTURES AND THE PROTECTION OF ADJACENT PROPERTY AND PUBLIC UNTIL COMPLETION OF THE PROJECT.
4. IT IS THE CONTRACTOR'S RESPONSIBILITY DURING THE COURSE OF THE WORK, TO BRING TO THE ATTENTION OF THE OWNER AND ENGINEER ANY DELETERIOUS CONDITIONS DISCOVERED WHERE NOT PREVIOUSLY IDENTIFIED.
5. CONTRACTOR SHALL IDENTIFY ALL ALTERNATE MATERIALS, METHODS OR CONSTRUCTION DETAILS TO THE OWNER AND ENGINEER FOR APPROVAL, PRIOR SUBMITTING QUOTATIONS.
6. CONTRACTOR SHALL HAVE SOLE RESPONSIBILITY FOR THE ACCURACY OF ALL MEASUREMENTS, ESTIMATES OF MATERIALS, QUANTITIES AND SIZES, AND SITE CONDITIONS THAT WILL AFFECT WORK.
7. REFER TO THE ARCHITECTURAL DRAWINGS AND SPECIFICATIONS FOR INFORMATION NOT SHOWN HEREIN.
8. CZAR ENGINEERING'S SERVICES LIMITED TO WORK AS DESCRIBED HEREIN ONLY. NO OTHER STRUCTURE HAS BEEN REVIEWED AND WE REFER TO THE BUILDING CONTRACT DOCUMENTS FOR ALL OTHER DESIGN INFORMATION. IF THE CLIENT, OWNER, CONTRACTOR, OR ANY OTHER INTERESTED PARTY ARE AWARE OF DEFICIENCIES IN THE BALANCE OF THE STRUCTURE, IT IS INCUMBENT UPON THEM TO NOTIFY THE ENGINEER IMMEDIATELY AND IN WRITING, AND TO OBTAIN AN ORDER FOR REPAIR FROM THE CLIENT, OWNER, CONTRACTOR, OR ARCHITECT. CZAR ENGINEERING AND/OR LAMONT & CZAR, P.C. CANNOT AND WILL NOT ACCEPT LIABILITY FOR DEFICIENCIES IN THE BALANCE OF THE STRUCTURE.

GENERAL REQUIREMENTS & CONDITIONS

1. WHERE A SECTION OR DETAIL IS SHOWN FOR ONE CONDITION, IT SHALL APPLY TO ALL LIKE CONDITIONS EVEN THOUGH NOT SPECIFICALLY MARKED ON THE PLANS.
2. CONTRACTOR SHALL BE RESPONSIBLE FOR PROTECTION OF THE STRUCTURE DURING CONSTRUCTION AGAINST EARTH PRESSURE, WIND, AND OTHER FORCES UNTIL PERMANENT SUPPORTS ARE IN PLACE.
3. WHERE NO SPECIFIC INFORMATION IS GIVEN, CONSTRUCTION SHALL BE PERFORMED IN ACCORDANCE WITH THE ARCHITECTURAL PLANS OR THE PRESCRIPTIVE REQUIREMENTS OF THE INTERNATIONAL BUILDING CODE.

WALL MOUNTED SIGN

1. WHENEVER INSTALLATION OF A SIGN ONTO NO LESS THAN A 1/2" GYPSUM WALLBOARD FACED HOLLOW WALL IS REQUIRED, THAT A MINIMUM WALL FASTENING SYSTEM SHALL CONSIST OF 3/8" BOLTS MANUFACTURED BY RANLUIG CO. OR BY ANOTHER MANUFACTURER AS MEETS THE MINIMUM STANDARDS THAT FOLLOW AND AS LOAD TESTED TO ASTM STANDARD E 488, WITH RATINGS TO BE FURTHER REDUCED BY A MINIMUM SAFETY FACTOR OF 4 TO DETERMINE WORKING LOAD:

- A. TENSION RATING $340 \text{ LBS.} / 4 = 85 \text{ LBS.}$
B. SHEAR RATING OF $440 \text{ LBS.} / 4 = 110 \text{ LBS.}$

2. SIGN SHALL BE FASTENED TO WALL SUBSTRATE AT NO LESS THAN 36" LATERAL INTERVALS ACROSS THE BACK OF SIGN AND AT A VERTICAL POSITION NO LOWER THAN ONE THIRD THE VERTICAL HEIGHT OF THE SIGN. WHENEVER POSSIBLE, BOLTS SHALL BE FASTENED INTO VERTICAL WALL STUD FOR ADDITIONAL SUPPORT.
3. WALL SHEATHING SHALL BE STRUCTURAL GL-24 OR SHEATHING GRADE, 1/2" APA RATED PLYWOOD MINIMUM, SECURED BY TEG SCREENS @ 12" O.C. IN FIELD, UNLESS NOTED OTHERWISE.

DESIGN LOAD SCHEDULE

GOVERNING CODE: 2016 NJBC, ASCE 7-10 AND ATC COUNCIL WEB APP FOR WIND SPEED MAPPING.

1. SIGN WEIGHT = 4300 POUNDS
2. LATERAL LOADS = 5 PSF
3. SEISMIC: $AV = AA = 0.06$
HAZARD EXPOSURE GROUP II
SOIL PROFILE TYPE S4 - COEFFICIENT = 2.0
PERFORMANCE CATEGORY B
RESPONSE MODIFICATION FACTOR $R = 4.5$
DEFLECTION AMPLIFICATION FACTOR $CD = 4.0$

CODES AND STANDARDS

1. THE STATE OF NEW JERSEY DEPARTMENT OF COMMUNITY AFFAIRS, CONSTRUCTION CODE ELEMENTS "UNIFORM CONSTRUCTION CODE"
2. INTERNATIONAL BUILDING CODE COUNCIL, INTERNATIONAL BUILDING CODE 2016, NEW JERSEY EDITION
3. ASCE 7-10 STANDARD FOR MINIMUM DESIGN LOADS FOR BUILDINGS AND OTHER STRUCTURES

STRUCTURAL NOTES

SCALE

4

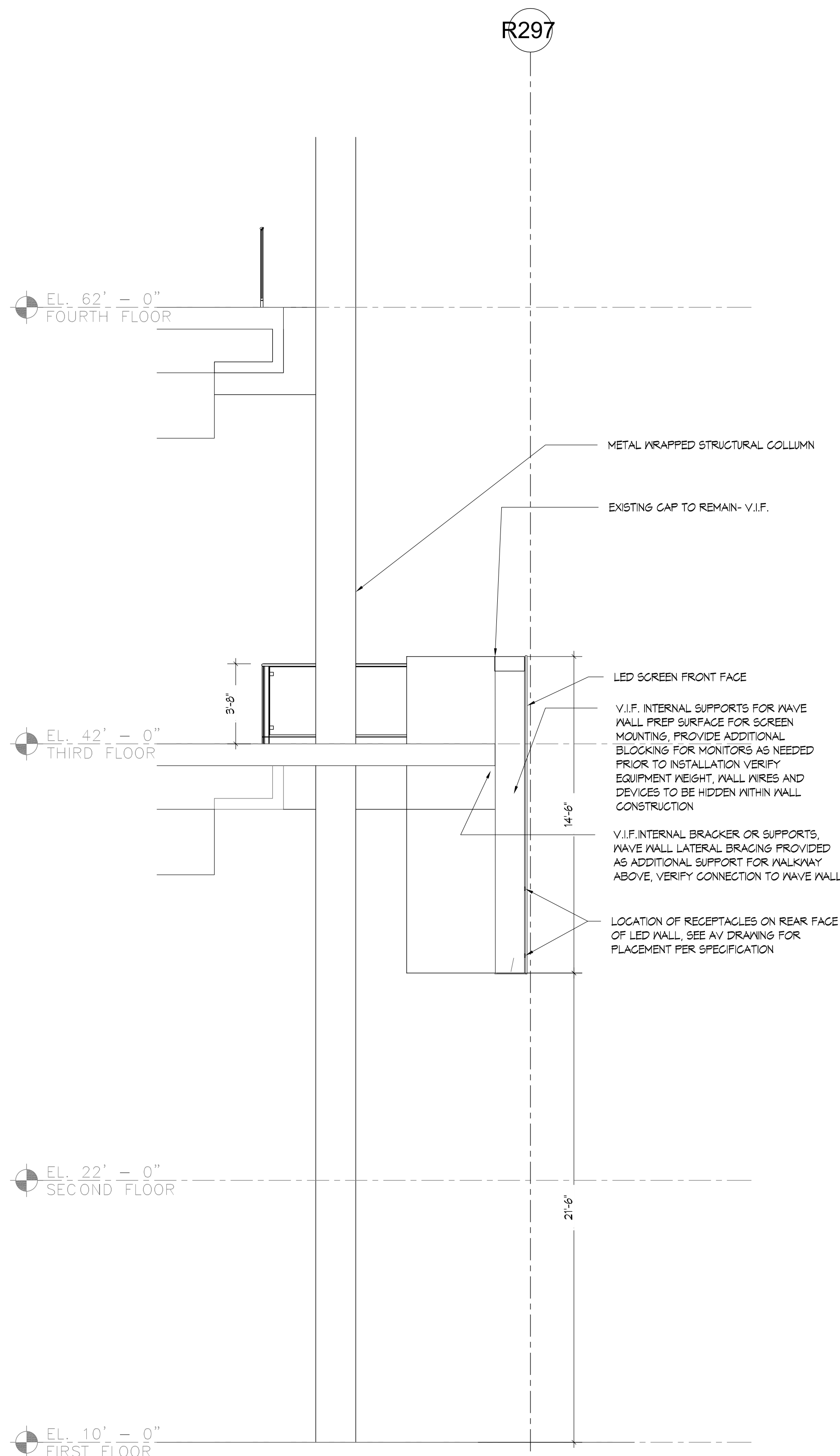

WAVE WALL- SECTION

SCALE
1.00 2.00 3.00 4.00 5.00 6.00 7.00 8.00 9.00 10.00

3

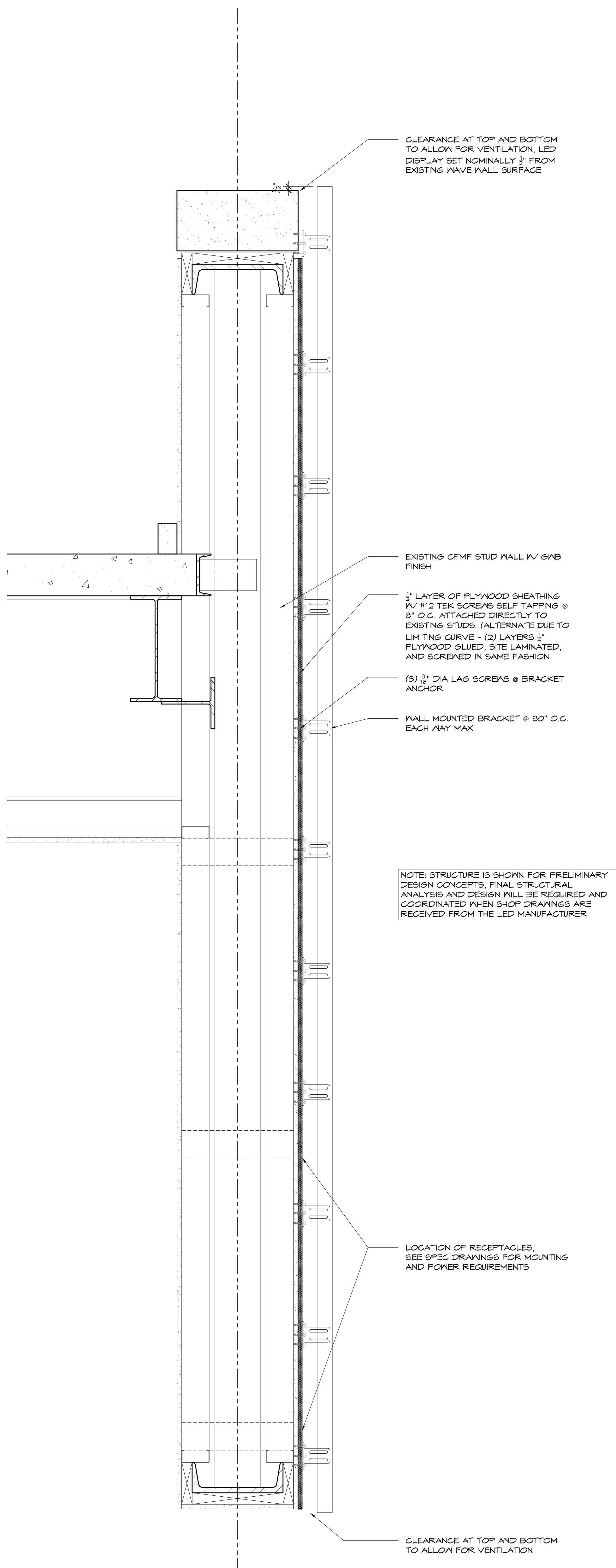

WAVE WALL- PROPOSED SECTION DETAIL

SCALE

2

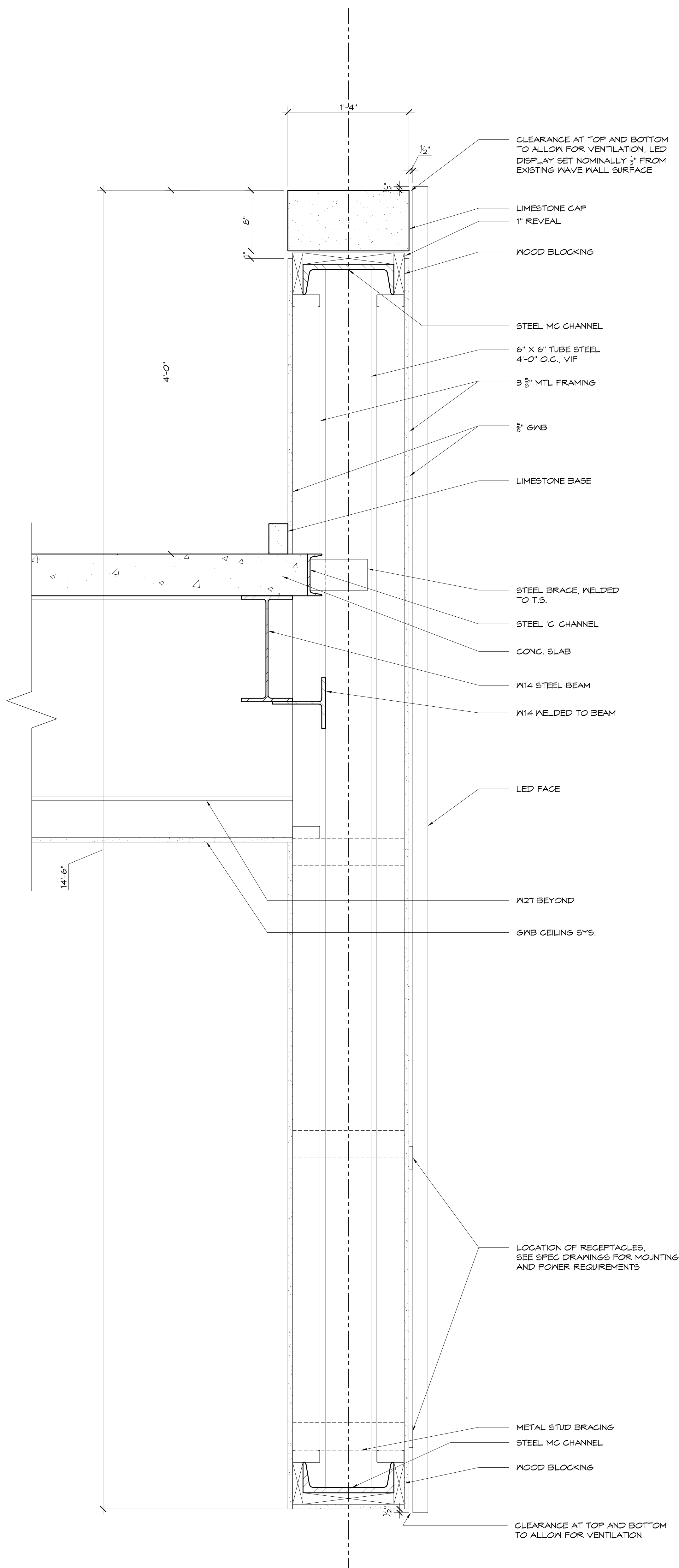

WAVE WALL- EXISTING SECTION DETAIL

SCALE
1 2 3 4 5 6 7 8 9 10

1

Thomas J. Sykes, A.I.A., P.P.
Founding Principal

William A. Salerno, A.I.A., P.P.
Founding Principal

Nory Hazaveh, A.I.A., P.P.
Founding Principal

Mark Petrella, A.I.A.
Principal

Christopher M. Menchini, NCARB
Principal

Kimberly McCarron, NCARB
Principal



Christopher Menchini - NJ License # 21A010 404000
www.soshighch.com



Atlantic City Convention Center
Atrium LED Sign
1 Convention Boulevard
Atlantic City, NJ 08401

SUBMISSIONS

[illegible]

DRAWING TITLE:

WAVE WALL
ENLARGED SECTION
& OVERALL SECTION

DRAWN BY:	JP	DRAWING NO.
REVIEWED BY:	CM	
PROJECT NO. 1701001.001		

A-831